

# ArcPad 48 Integral <sup>tm</sup>



Client: \_\_\_\_\_

Project: \_\_\_\_\_

Specifier: \_\_\_\_\_

Type: \_\_\_\_\_ Qty: \_\_\_\_\_



**FEATURES:**

- Input Voltage: 100-240VAC 50/60Hz (Optional 277V)
- Power consumption: 60W
- Light Source: 48 x High Power LED's
- Delivered Lumen: 2652lm 13° Cool white
- Projected LED Life: 60,000 Hrs
- Control: DMX Controller
- Housing: Cast Aluminium - Glass cover
- Fixing Method: Mounting Plate
- IP Rating: IP67
- Operating Ambient Temp: -20°C/+40°C [-4°F/+104°F ]
- Certification: ETL / cETL, CE, RoHS
- 5 Year Warranty

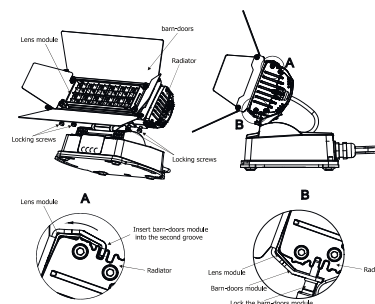
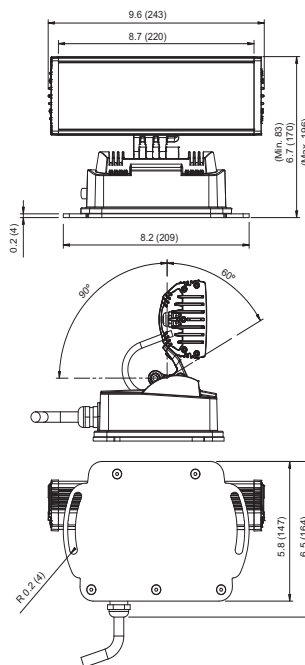

## Connection Scheme:

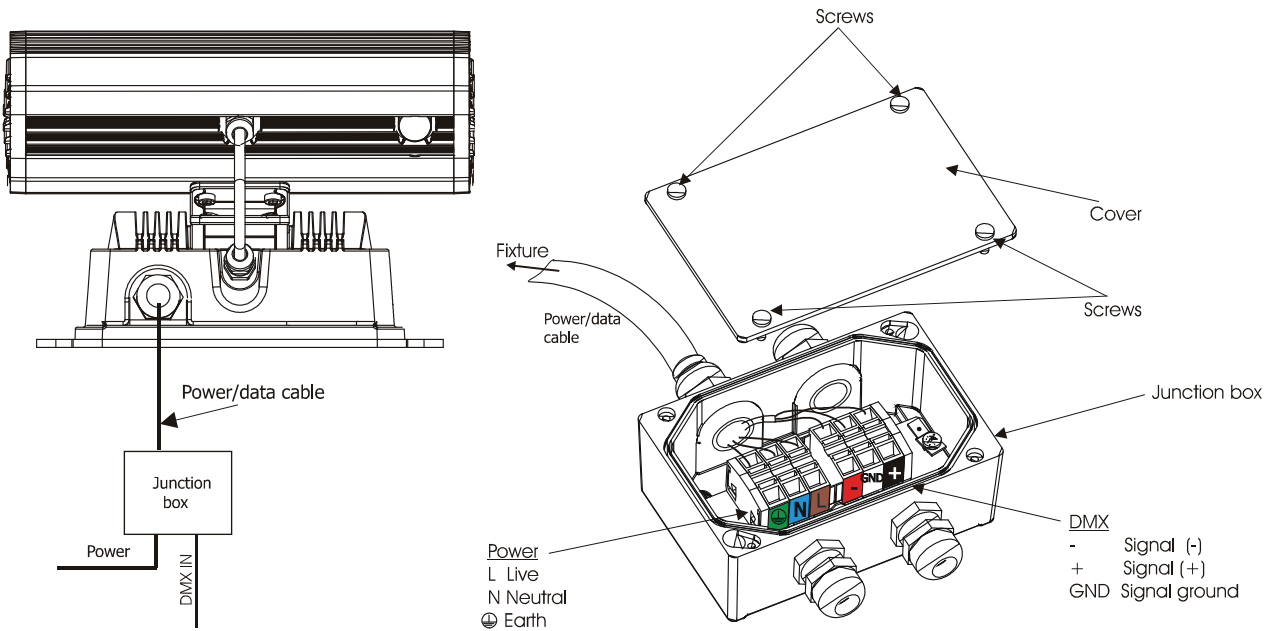

## Accessories:



Barn Door Module

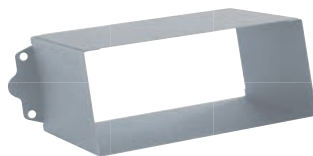

Top Hat Module



Half Top Hat Module

## Product Specification:

Electrical	Input Voltage		100-240 VAC, 50/60 Hz (Optional 277V)
	Power Consumption		60W +/- 10%
Optical	Light Source		48 x High Power LED's
		RGBW	W = WW-3000K - CW-6500K
		PW	3000K, 4000K, 6500K
		SW	3000K-6500K
	LED Channels		Red / Green / Blue / White, Pure White, Smart White
Beam Angle		13°, 26°, 45°, 13°x38°	
Projected Lumen Maintenance		60,000 hrs ( L70@ 25°C / 77°F)	
Control	Wireless DMX (Optional Accessory)		Lumen Radio CRMX Technology
	Control System		Anolis Lighting Controls or any Third Party DMX512 Controller
	Power Supply		Integral
	Stand Alone Control		Yes
Physical	Width x Height x Depth	Inches	9.6 x 6.82 x 6.78
		mm	243 x 173 x 172
	Weight	lbs	6.62
		kg	3
	Housing		High Pressure Die-Cast Aluminium Body Tempered Glass
	Fixture Cable and Connections		Igus CF9.03.08 - 0.5m Long (1.64ft) - Chogori IP68 Connector
		Integral Version	Li9YCHY - 3xAWG16+1 (2xAWG24) + Junction Box
	Fixing Method		Mounting Plate
	Adjustability		Pan +/-45°, Tilt +60° -90° (Pan +/-17°, Tilt +60° -90° Integral)
	IP Rating		IP67 (IP66 Junction box)
	IK Rating		IK**
	Cooling System		Convection
	Operating Ambient Temperature		-20°C / +40°C (-4°F / +104°F )
Operating Temperature		+70°C @ Ambient +25°C (+158°F @ Ambient +77°F )	
	Integral Version	+80°C @ Ambient +40°C (+176°F @ Ambient +104°F )	
Certification	Listings		ETL / cETL, CE, RoHS

Accessories	Description
	Junction Box (Included)
	Gasket Cable Grommet M20 (included)
	Barn Doors
	Top Hat
	Half Top Hat



## Photometric Data:

ArcPad 48 Integral CW - 12°

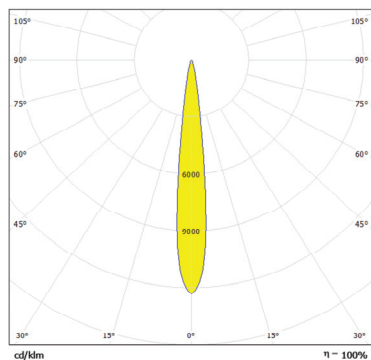

Distance [m]	Cone Diameter [m]	E(0°)	E(C90)	E(C180)
0.5	0.11	130776	64°	65277
1.0	0.22	32694	64°	16994
1.5	0.34	14531	64°	7264
2.0	0.45	8174	64°	4066
2.5	0.56	5231	64°	2615
3.0	0.67	3633	64°	1816

Distance [m] Cone Diameter [m] Illuminance [lx]  
 — C0 - C180 (Half-value Angle: 12.8°)  
 — C90 - C270

Total Luminous Flux: 2652lm

ArcPad 48 Integral CW - 25°

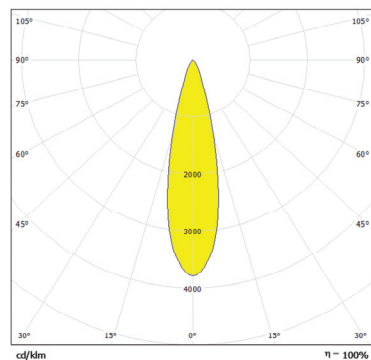

Distance [m]	Cone Diameter [m]	E(0°)	E(C90)	E(C180)
0.5	0.23	36472	12.8°	18911
1.0	0.45	9118	12.8°	4629
1.5	0.68	4052	12.8°	1879
2.0	0.91	2380	12.8°	1027
2.5	1.14	1459	12.8°	676
3.0	1.36	1013	12.8°	470

Distance [m] Cone Diameter [m] Illuminance [lx]  
 — C0 - C180 (Half-value Angle: 25.8°)  
 — C90 - C270

Total Luminous Flux: 2406lm

For foot Candles divide lux by 10.7

ArcPad 48 Integral CW - 45°

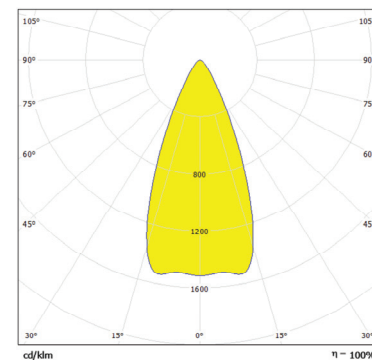

Distance [m]	Cone Diameter [m]	E(0°)	E(C90)	E(C180)
0.5	0.42	13642	22.6°	5486
1.0	0.83	3410	22.6°	1372
1.5	1.25	1516	22.6°	610
2.0	1.67	883	22.6°	343
2.5	2.08	546	22.6°	219
3.0	2.50	379	22.6°	152

Distance [m] Cone Diameter [m] Illuminance [lx]  
 — C0 - C180 (Half-value Angle: 45.2°)  
 — C90 - C270

Total Luminous Flux: 2252lm

ArcPad 48 Integral CW - 38° x 13°

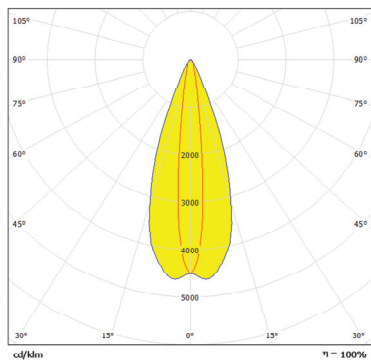

Distance [m]	Cone Diameter [m]	E(0°)	E(C90)	E(C180)
0.5	0.34	46547	18.9°	19500
1.0	0.68	11137	18.9°	4897
1.5	1.03	4950	18.9°	2177
2.0	1.37	2794	18.9°	1224
2.5	1.71	1782	18.9°	794
3.0	2.05	1237	18.9°	544

Distance [m] Cone Diameter [m] Illuminance [lx]  
 — C0 - C180 (Half-value Angle: 12.8°)  
 — C90 - C270 (Half-value Angle: 37.8°)

Total Luminous Flux: 2470lm

Photometric Data:

ArcPad 48 Integral RGBCW - 12°

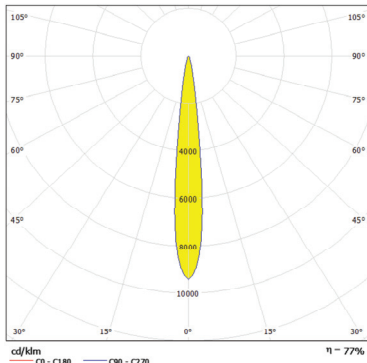

Distance [m]	Cone Diameter [m]	E(0°) E(C0)	E(0°) E(C20)
0.5	0.11	109000 6.4° 52038	
1.0	0.22	26225 6.4° 13123	
1.5	0.34	11656 6.4° 5794	
2.0	0.45	6556 6.4° 3254	
2.5	0.56	4196 6.4° 2062	
3.0	0.67	2914 6.4° 1446	

Distance [m] Cone Diameter [m] Illuminance [lx]  
C0 - C180 (Half-value Angle: 12.8°)  
C90 - C270

Total Luminous Flux: 2519lm

ArcPad 48 Integral RGBCW - 38° x 13°

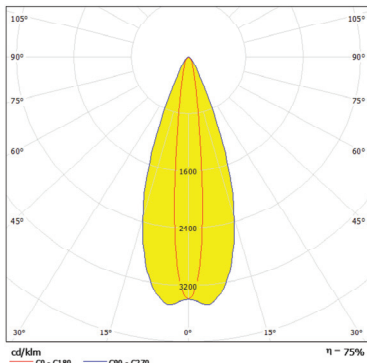

Distance [m]	Cone Diameter [m]	E(0°) E(C0)	E(0°) E(C90)	E(0°) E(C180)
0.5	0.15 0.11	32185 18.2° 13008 6.3° 19940		
1.0	0.70 0.22	8046 19.2° 3480 6.3° 5907		
1.5	1.04 0.33	3576 19.2° 1547 6.3° 1772		
2.0	1.39 0.44	2012 19.2° 876 6.3° 997		
2.5	1.74 0.55	1287 19.2° 557 6.3° 638		
3.0	2.09 0.66	894 19.2° 387 6.3° 443		

Distance [m] Cone Diameter [m] Illuminance [lx]  
C0 - C180 (Half-value Angle: 12.6°)  
C90 - C270 (Half-value Angle: 38.4°)

Total Luminous Flux: 2364lm

ArcPad 48 Integral RGBCW - 25°

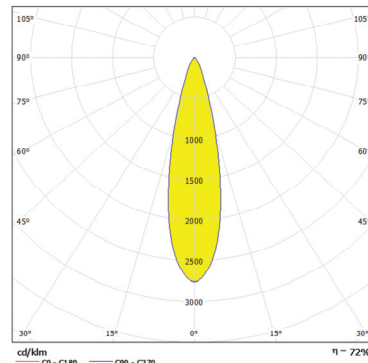

Distance [m]	Cone Diameter [m]	E(0°) E(C0)	E(0°) E(C10)	E(0°) E(C20)
0.5	0.23	30780 12.7° 14256		
1.0	0.45	7676 12.7° 3264		
1.5	0.68	3411 12.7° 1584		
2.0	0.90	1919 12.7° 891		
2.5	1.13	1228 12.7° 570		
3.0	1.35	853 12.7° 396		

Distance [m] Cone Diameter [m] Illuminance [lx]  
C0 - C180 (Half-value Angle: 25.4°)  
C90 - C270

Total Luminous Flux: 2285lm

For foot Candles divide lux by 10.7

ArcPad 48 Integral RGBCW - 45°

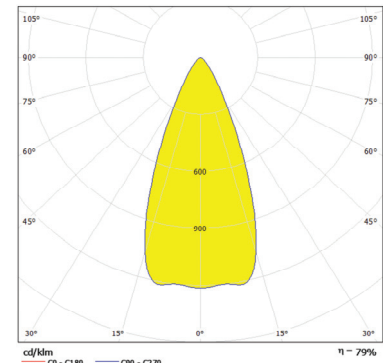

Distance [m]	Cone Diameter [m]	E(0°) E(C0)	E(0°) E(C10)	E(0°) E(C20)
0.5	0.42	13811 22.6° 5353		
1.0	0.83	3378 22.6° 1308		
1.5	1.25	1501 22.6° 595		
2.0	1.67	844 22.6° 335		
2.5	2.09	540 22.6° 214		
3.0	2.50	375 22.6° 149		

Distance [m] Cone Diameter [m] Illuminance [lx]  
C0 - C180 (Half-value Angle: 45.2°)  
C90 - C270

Total Luminous Flux: 2139lm

## Photometric Data:

ArcPad 48 Integral SW - 12°

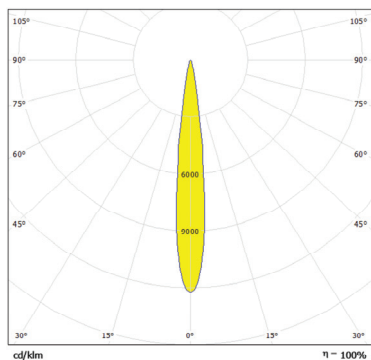

Distance [m]	Cone Diameter [m]	E(0°) E(C0)	E(64°) E(C270)	Illuminance [lx]
0.5	0.11	137511	66203	
1.0	0.22	34378	17051	
1.5	0.34	15279	7578	
2.0	0.45	8994	4263	
2.5	0.56	5500	2708	
3.0	0.67	3820	1895	

Distance [m] Cone Diameter [m] Illuminance [lx]  
 — C0 - C180 (Half-value Angle: 12.8°)  
 — C90 - C270

Total Luminous Flux: 2805lm

ArcPad 48 Integral SW - 25°

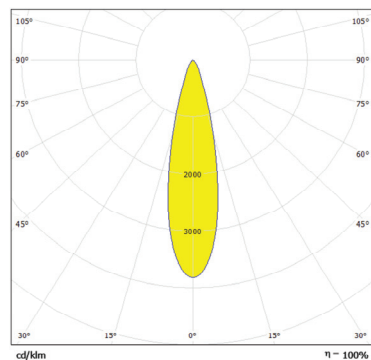

Distance [m]	Cone Diameter [m]	E(0°) E(C0)	E(12.5°) E(C90)	Illuminance [lx]
0.5	0.22	39988	18325	
1.0	0.44	9774	4581	
1.5	0.67	4344	2036	
2.0	0.89	2444	1145	
2.5	1.11	1564	753	
3.0	1.33	1086	509	

Distance [m] Cone Diameter [m] Illuminance [lx]  
 — C0 - C180 (Half-value Angle: 25.0°)  
 — C90 - C270

Total Luminous Flux: 2557lm

For foot Candles divide lux by 10.7

ArcPad 48 Integral SW - 45°

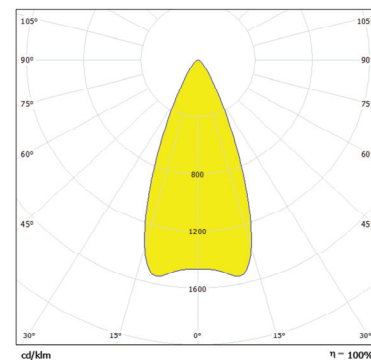

Distance [m]	Cone Diameter [m]	E(0°) E(C0)	E(22.5°) E(C90)	Illuminance [lx]
0.5	0.41	14011	5990	
1.0	0.83	3553	1480	
1.5	1.24	1579	660	
2.0	1.66	888	371	
2.5	2.07	568	258	
3.0	2.49	395	185	

Distance [m] Cone Diameter [m] Illuminance [lx]  
 — C0 - C180 (Half-value Angle: 45.0°)  
 — C90 - C270

Total Luminous Flux: 2422lm

ArcPad 48 Integral SW - 38° x 13°

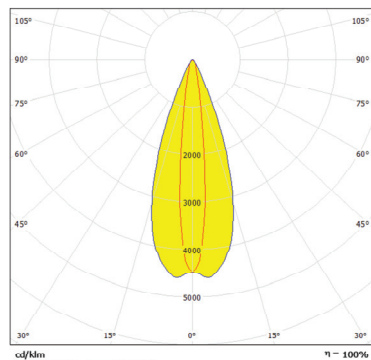

Distance [m]	Cone Diameter [m]	E(0°) E(C38)	E(18.8°) E(C13)	E(6.5°) E(C0)	Illuminance [lx]
0.5	0.34 0.11	49813	20312	22616	
1.0	0.68 0.22	12428	5053	5654	
1.5	1.02 0.34	5990	2490	2513	
2.0	1.36 0.46	2963	1263	1413	
2.5	1.70 0.57	1833	808	905	
3.0	2.04 0.68	1273	561	628	

Distance [m] Cone Diameter [m] Illuminance [lx]  
 — C0 - C180 (Half-value Angle: 13.0°)  
 — C90 - C270 (Half-value Angle: 37.6°)

Total Luminous Flux: 2560lm

Photometric Data:

ArcPad 48 Integral WW - 12°

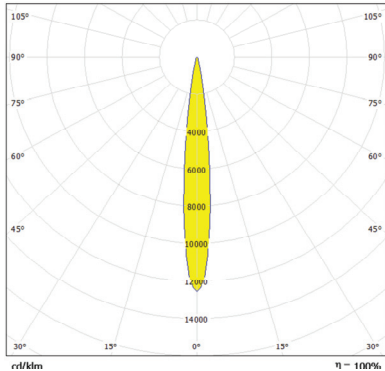

Distance [m]	Cone Diameter [m]	E(0°)	E(C0)	E(C270)
0.5	0.11	128642	6.2°	62693
1.0	0.22	31641	6.2°	15653
1.5	0.33	14062	6.2°	6966
2.0	0.43	7919	6.2°	3918
2.5	0.54	5062	6.2°	2588
3.0	0.65	3516	6.2°	1741

Distance [m] Cone Diameter [m] Illuminance [lx]  
 — C0 - C180 (Half-value Angle: 12.0°)  
 — C90 - C270 (Half-value Angle: 12.0°)

Total Luminous Flux: 2522lm

ArcPad 48 Integral WW - 25°

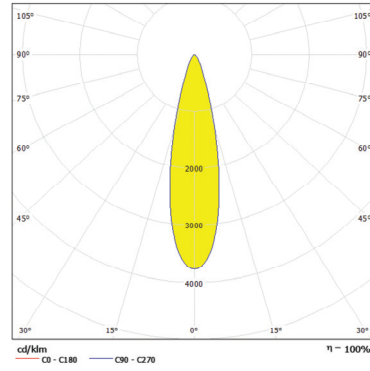

Distance [m]	Cone Diameter [m]	E(0°)	E(C0)	E(C270)
0.5	0.22	34242	12.5°	16111
1.0	0.44	8560	12.5°	4008
1.5	0.67	3805	12.5°	1790
2.0	0.89	2340	12.5°	1007
2.5	1.11	1370	12.5°	644
3.0	1.33	951	12.5°	448

Distance [m] Cone Diameter [m] Illuminance [lx]  
 — C0 - C180 (Half-value Angle: 25.0°)  
 — C90 - C270 (Half-value Angle: 25.0°)

Total Luminous Flux: 2270lm

For foot Candles divide lux by 10.7

ArcPad 48 Integral WW - 45°

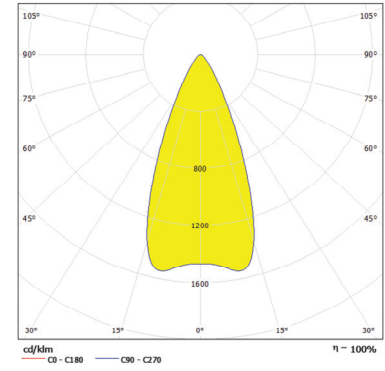

Distance [m]	Cone Diameter [m]	E(0°)	E(C0)	E(C270)
0.5	0.41	13881	22.4°	5388
1.0	0.82	3220	22.4°	1247
1.5	1.24	1431	22.4°	599
2.0	1.65	865	22.4°	337
2.5	2.06	515	22.4°	216
3.0	2.47	358	22.4°	150

Distance [m] Cone Diameter [m] Illuminance [lx]  
 — C0 - C180 (Half-value Angle: 44.8°)  
 — C90 - C270 (Half-value Angle: 44.8°)

Total Luminous Flux: 2190lm

ArcPad 48 Integral WW - 38° x 13°

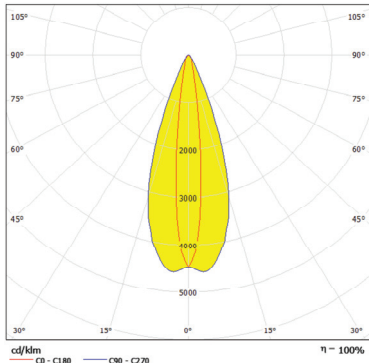

Distance [m]	Cone Diameter [m]	E(0°)	E(C0)	E(C180)	E(C90)	E(C270)
0.5	0.34	42007	18.0°	18666	6.5°	20941
1.0	0.68	10502	18.0°	4601	6.5°	5235
1.5	1.03	4657	18.0°	2095	6.5°	2327
2.0	1.37	2825	18.0°	1250	6.5°	1309
2.5	1.71	1680	18.0°	736	6.5°	808
3.0	2.05	1167	18.0°	511	6.5°	562

Distance [m] Cone Diameter [m] Illuminance [lx]  
 — C0 - C180 (Half-value Angle: 13.0°)  
 — C90 - C270 (Half-value Angle: 37.8°)

Total Luminous Flux: 2353lm