

ArcSource Out 4 MC Pixel

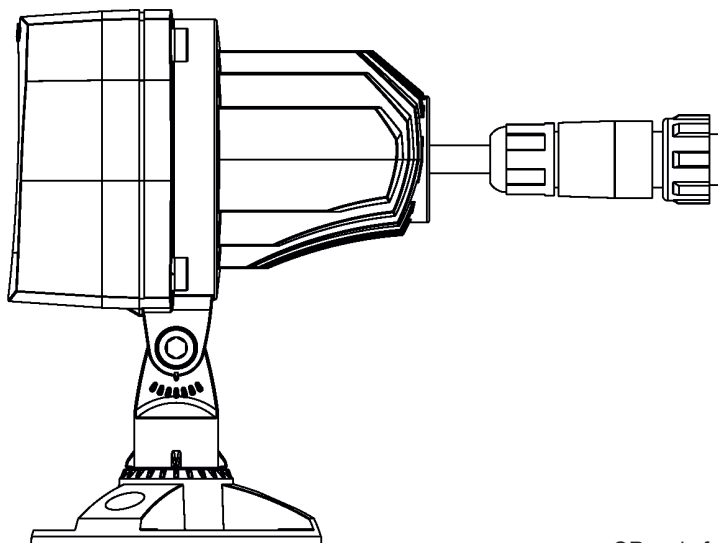

QR code for user manual



USER MANUAL

Version 2.0 US

The ArcSource Out 4 MC Pixel is a multi-purpose, high-intensity RGBW LED node for generating a wide variety of effects without the limitations associated with a solid fixture unit. The unit's high light output can be pixel mapped and therefore can be controlled and used for large scale matrix applications, as well as used for individual illuminating needs.

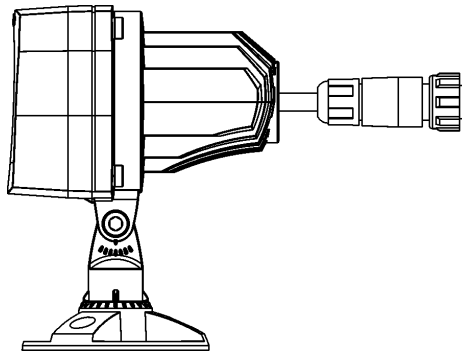

1.Attention

Consider the respective national norms during the installation!

Do not install the module near high inflammable liquids or materials

Do not allow anything to rest on the module

Do not install the unit near naked flames.

Avoid using the unit in locations subject to possible impacts.

Do not attempt to dismantle or modify the unit.

Do not install the module in badly ventilated location

Warning: Operation of this equipment in a residential environment could cause radio interference.

Resistance of the equipment is designed for electromagnetic environments E1, E2, E3 according to the standard EN55103-2 ed.2 Electromagnetic compatibility. Product family standard for audio, video, audiovisual and entertainment lighting control apparatus for professional use. Part 2: Immunity.

The installation company should check levels of possible interferences above the tested levels E1,E2,E3 given by this standard (e.g. transmitters in surrounding area) before installing the equipment.

Emission of the equipment complies with the standard EN55032 Electromagnetic compatibility of multimedia equipment – Emission Requirements according to class A.

2.Installation

The ArcSource Out 4 MC Pixel can be arranged in any position orientation. Three holes of diameter of 4.3mm in the ArcSource Out's base serve for mounting on the non-flammable surface. The light head can be adjusted against the base in range of 120°. The ArcSource Out 4 MC Pixel unit should be connected to the power supplies stated in the Technical specifications. See their user manuals for full details of mains power requirements, DMX operation and installation. As the ArcSource Out 4 MC Pixel-US is equipped with one input cable only, the T-connector Chogori has to be used for connecting ArcSource Out 4 MC Pixel modules each other.

CAUTION!

Avoid looking directly into the LED light beam at close range!

The enclosed adapter stand (with M5x45 screw) allows to place light head higher:

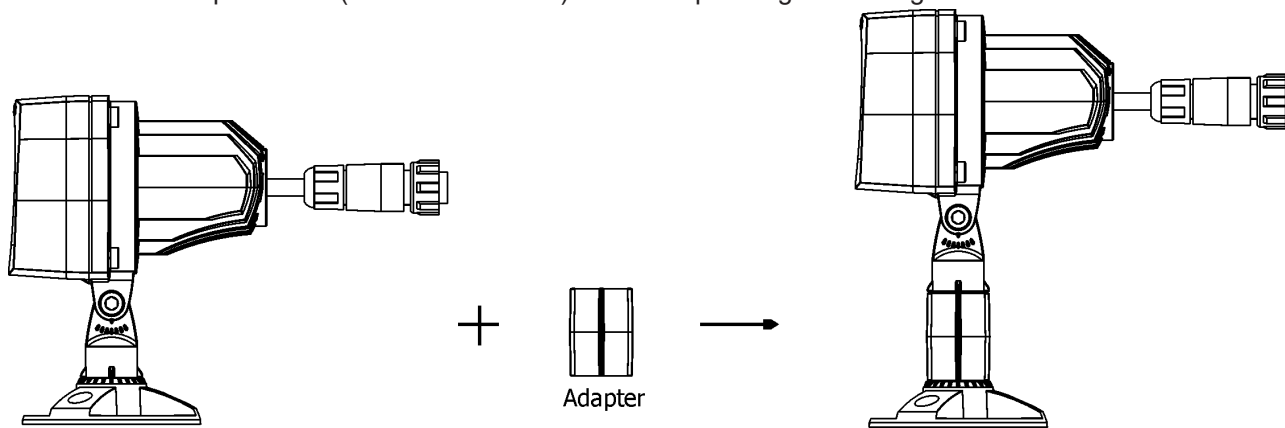

Use the following way for connecting of the ArcSource Out 4 MC Pixel only (examples for matrix of 4x4):

Horizontal sorting

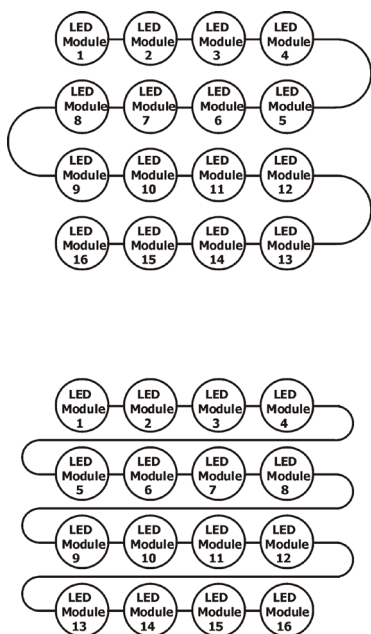

Vertical sorting

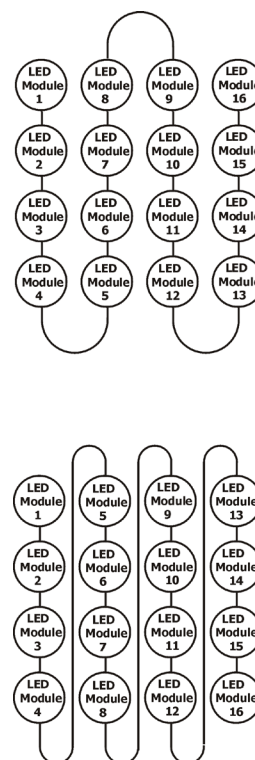

3. Wiring of the ArcSource Out 4 MC Pixel connector

Chogori CGRBB-03BMMA-SL8001 (male)

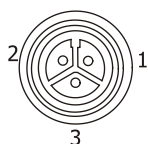

- 1 GND (blue wire)
- 2 +48V (red wire)
- 3 Data (orange wire)

4. Technical specifications

LED device:	Osram Ostar RGBW multichip
Max. current per colour:	520 mA
Maximum power consumption:	5.5 Watts/48V
Power supply:	50 V DC max ;suitable for damp locations 30 V DC max. ;suitable for wet locations
Compatible power supplies:	ArcPixel Power-US, ArcPower Unit Pixel Rack Mount US, ArcPower Unit Pixel Wall Mount US, ArcPower Unit Pixel Rack Mount US LV, ArcPower Unit Pixel Wall Mount US LV, DRS
Available beam angles:	7°, 13°, 20°, 30°, 40°, 60°, 90°, 7° x 30°, 30° x 7°, 7° x 60°, 60° x 7°, 35° x 70°, 70° x 35°, 10° x 90°, 90° x 10°
Projected Lumen Maintenance:	L90B10 >90.000 hrs, Ta = 25°C / 77°F
Cooling system:	convection
Operating ambient temp. range:	-20°C/+45°C
Housing:	alluminium
Weight:	0.43 kg / 0.95 lbs
Mounting:	via 3 holes in the base
Data cable:	Li9Y11Y, 2xAWG16+1xAWG 20 (length according requirement, standard is 0.5m)

5. Accessories

1x Adapter stand (P/N 19730251), 1x Screw M5x45
1x Allen key 4

6. Optional accessories (quantity depends on size of installation)

(P/N 13051562) Connector Chogori CGRBB-03BMMA-SL8001 (male)
(P/N 13051564) T-connector Chogori T-CGRBA-030303FFM-TS
(P/N 13052784) Cable Connection DRS/RU Pixel (CGR-F/bare,3pin, 1.5m)
(P/N 13052738) Cable Connection DRS/RU Pixel (CGR-F/bare,3pin, 0.2m)
(P/N 1305 2023) Connection cable, 2m
(P/N 1305 2024) Connection cable, 4m
(P/N 1006 2330) Active Terminator for ArcDot
(P/N 1006 2331) Passive Terminator for ArcDot
(P/N 10980273) Top hat ArcSource Outdoor 4 MC
(P/N 10980253) Half top hat ArcSource Outdoor 4 MC

6. Dimensions (mm)

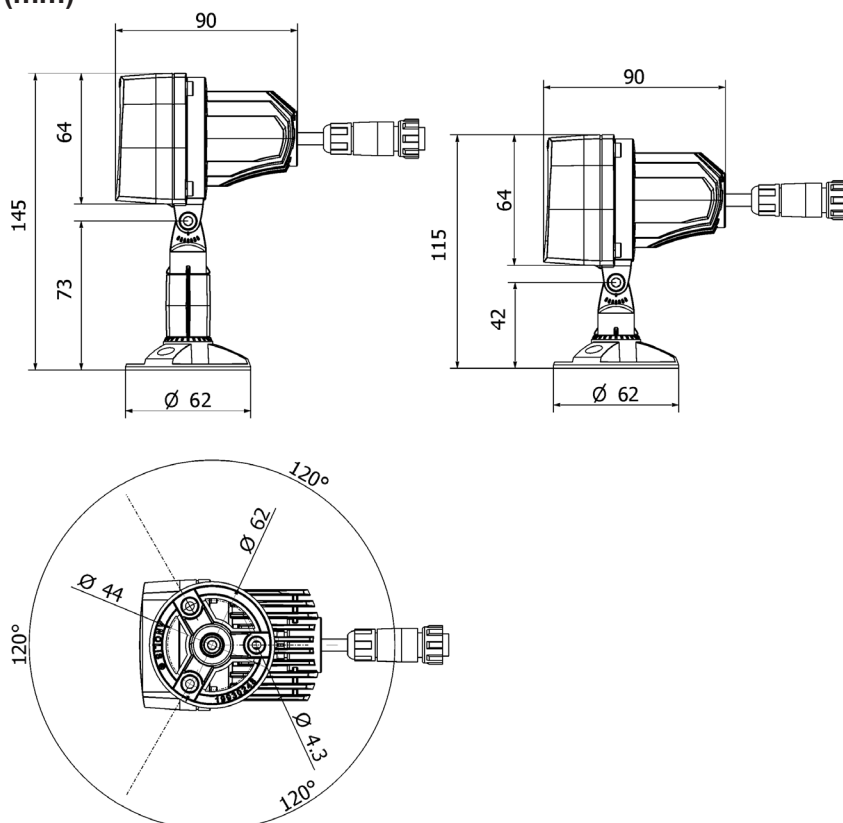

7. Installing the top hat (half top hat)

1. Unscrew the Allen head screw (1) from the ArcSource Outdoor 4 MC housing.
2. Insert the distance part (4) into the housing of the ArcSource Outdoor 4 MC and place the top hat (half top hat) (5) on the housing (6).
3. Screw the Allen head screw (1) back to the housing with a spring washer (2) and flat washer (3). The small hook (7), which secures the top hat (half top hat) to the housing, has to be placed between the distance part (4) and the flat washer (3). Check the Allen head screw is fully tightened.

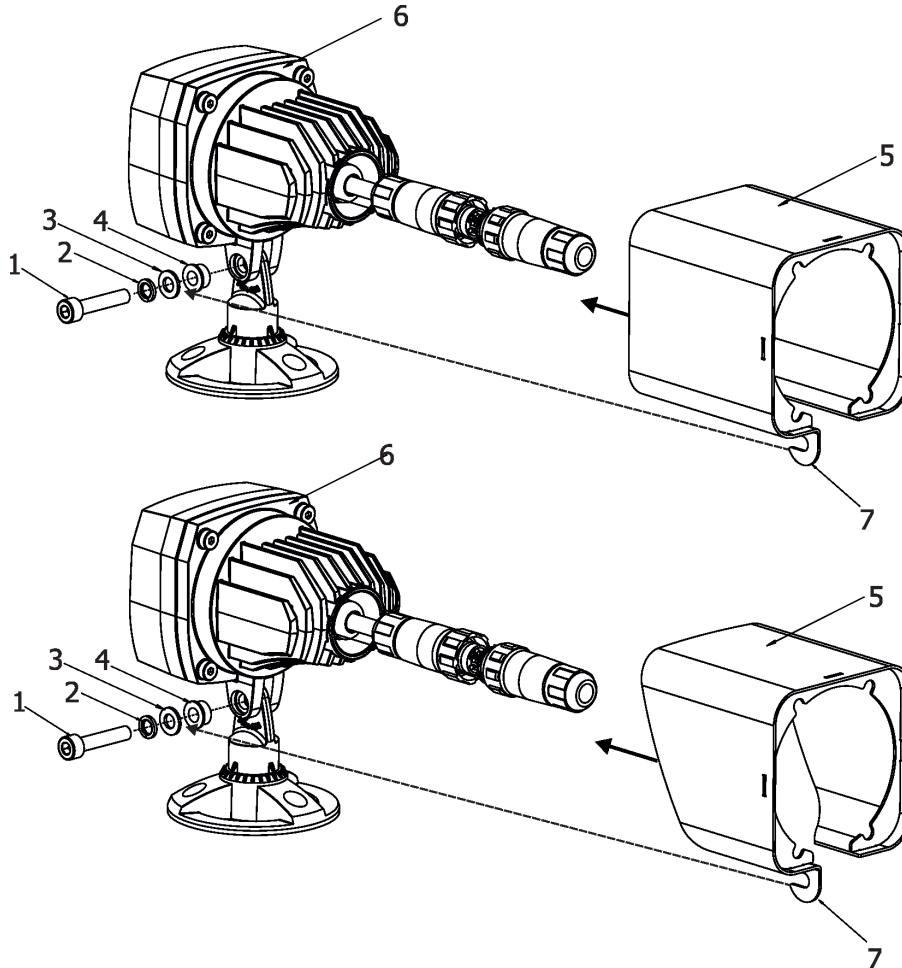

July 11, 2022

Specifications are subject to change without notice.

Made in CZECH REPUBLIC by ROBE LIGHTING s.r.o. Palackeho 416/20 CZ 75701 Valasske Mezirici