

User instructions

ArcSource 140 COB Recessed

The lighting unit generates light by means of high power LED multichip. The product was designed for installation to a lower ceiling and is intended for indoor use only.

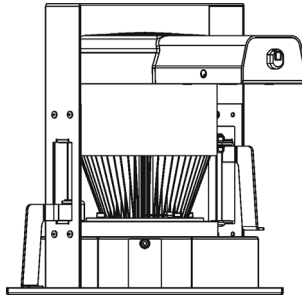

1. Attention

The unit must be installed by a qualified electrician in accordance with all national and local electrical and construction codes and regulations. The unit was designed for indoor use only.

Avoid looking directly into the LED light beam at close range!

Do not install the unit near highly inflammable liquids or materials.

Do not allow anything to rest on the unit.

Do not install the unit near an open flame.

Do not install the unit in dirty, dusty or badly ventilated location.

Sufficient air accessing to the housing of the unit has to be ensured, there must not be any heat or anti-noise insulation around 0.6m x 0.6m around the unit (non-IC rated fixture).



Suitable for fastening on non-flammable surfaces only



Unsuitable for covering by heat insulation material

2. Installation

1. Prepare a circular opening in the lower ceiling (1) as shown at the picture below.
2. Insert the ArcSource 140 COB Recessed into the opening. Both adjustable rests (3) must be turned at bracket (4) position to pass them through the aperture.

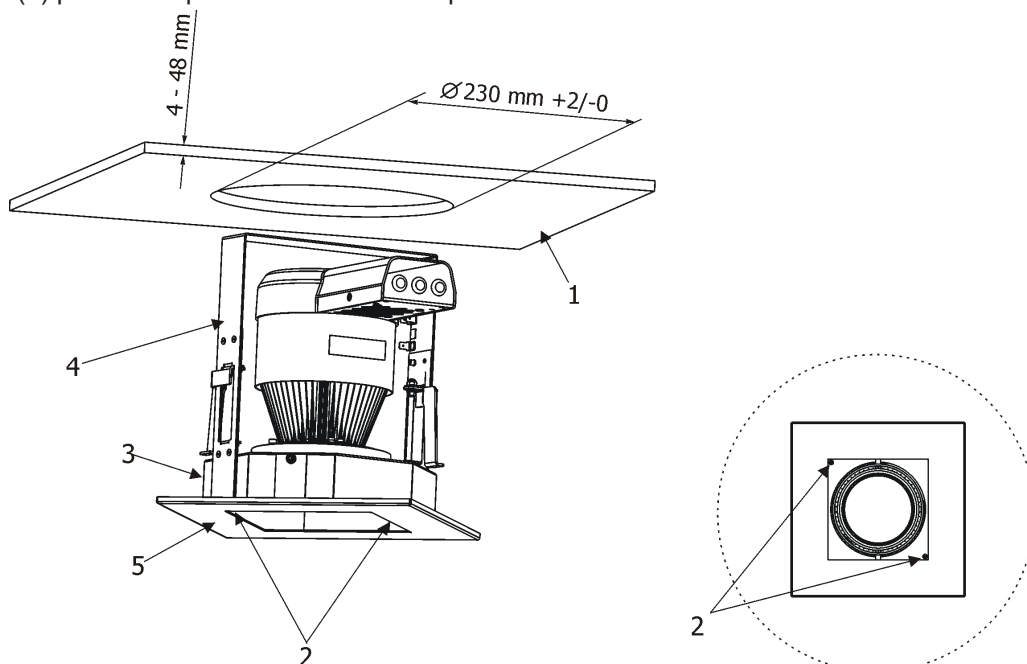

3. Turn adjustable rests (3) towards the lower ceiling (1).
4. Pass a cross-point screwdriver through aperture (2) and a screw (clockwise) the adjustable rest (3) until it firmly supports against the lower ceiling. Repeat this adjustment for second adjustable rest. Now the lower ceiling (1) is "squeezed" between adjustable rest (3) and frame (5) of the ArcSource 140 Recessed COB.
5. The light head can be tilted 15° from a vertical axis.

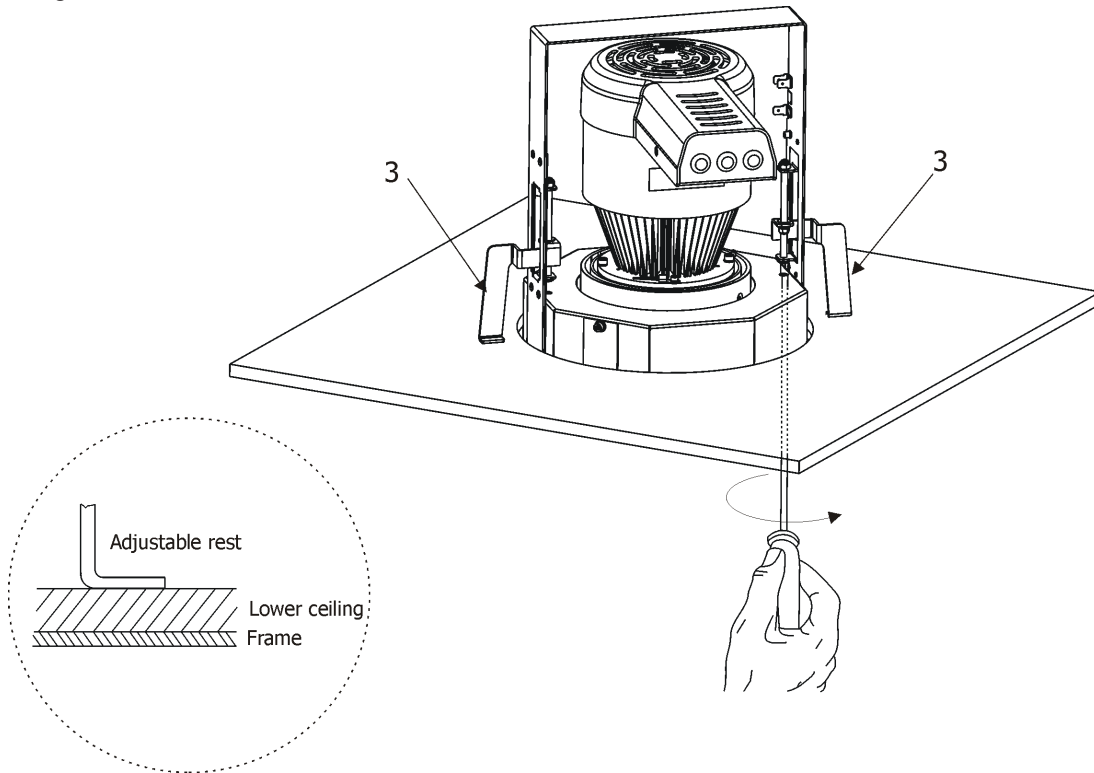

6. Connect cables to the ArcSource 140 COB Recessed.

3. ArcSource 140 COB Recessed connection

Always switch off power supply of the unit before connecting or disconnecting the unit

To connect needed cables to the fixture, unscrew three screws (6) from the plastic cover (7).

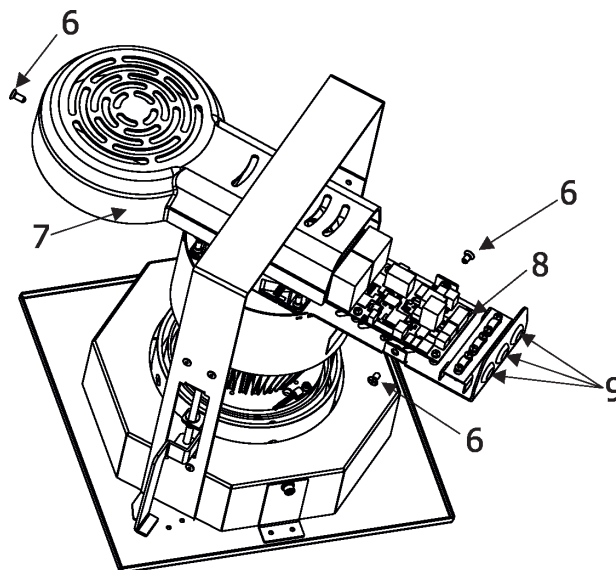

Connect a cable to the suitable connection block (8). To pass the cable through the cable gland (9), make an opening in the blank cable gland (9).

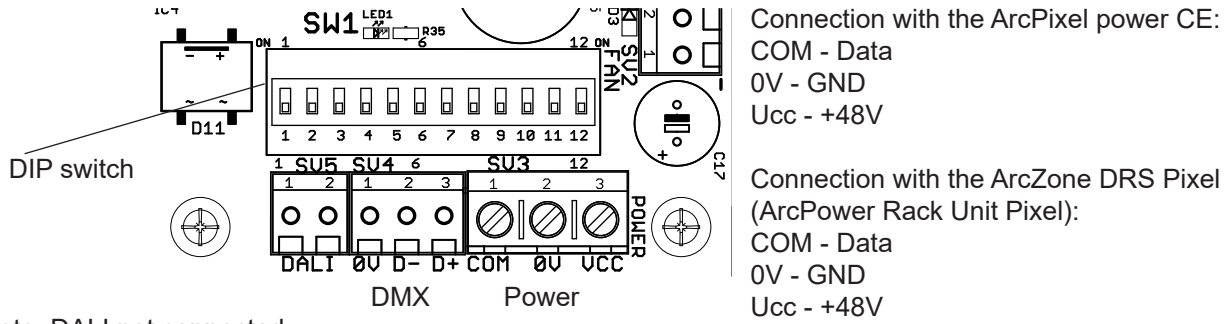

Note: DALI not connected.

4. DMX address setting and control

The fixture can be controlled by one of the following method: DMX 512
 ArcPixel Power CE
 (or ArcZone DRS Pixel or ArcPower Rack Unit pixel)

The DIP switch, located next to the connection blocks, allows to set a DMX address and also allows to switch the fixture to the update mode in case of software update.

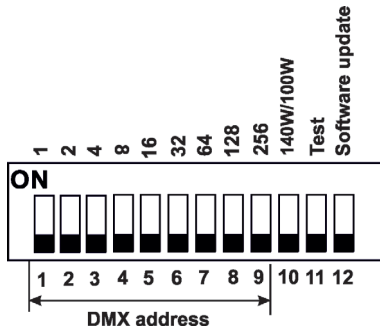

- DIP 10 - ON=100W, OFF=140W.
- DIP 11 - ON=test (full light output)
- DIP 12 - change from OFF to ON position switches the fixture to the update mode.

DMX control

The DMX start address, is the first channel used to receive instructions from the DMX controller. The address may be any channel from 1 to 512.
 Example of DMX addresses:



8. DMX chart

Version 1.1

Channel	Value	Function	Type of control
1	0-255	Dimmer (8 bit) Dimmer intensity from 0% to 100%	proportional

9. Dimensions

(All dimensions are in mm)

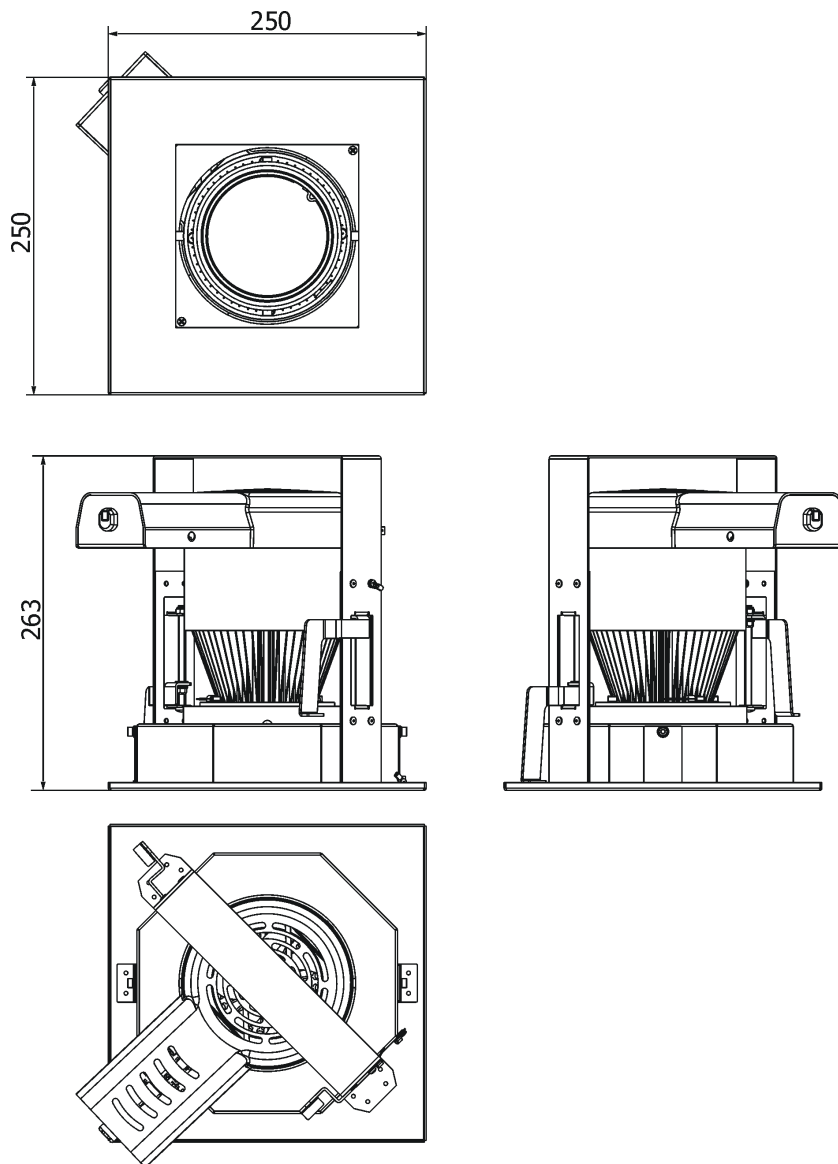

10. Optional Accessories

- (P/N 10980299) Anti Glare Louvre AS 140 COB black
- (P/N 10980300) Anti Glare Louvre AS 140 COB white
- (P/N 10980301) Anti Glare Louvre AS 140 COB silver
- (P/N 10980302) Diffuser Holder AS 140 COB black
- (P/N 10980303) Diffuser Holder AS 140 COB white
- (P/N 10980304) Diffuser Holder AS 140 COB silver
- (P/N 10980305) Diffuser 28° for AS 140 COB 23deg
- (P/N 10980306) Diffuser 40° for AS 140 COB 23deg
- (P/N 10980307) Diffuser 50° for AS 140 COB 23deg
- (P/N 10063036) ArcPower CLG-150-48 MW (for EU only)

11. Maintenance

Keep the fixture clean, especially Diffuser and the ribbed housing.

12. Software update

The following are required in order to update software:

- PC running Windows /XP/7/8/10 or Linux
- Software Uploader
- Robe Universal Interface

To update software in the fixture:

I. Installation of the Software Uploader.

1. The Software Uploader program is available from the Anolis web site at WWW.anolis.cz.
2. Download the software to your PC.

II. Fixture software updating.

1. Connect the Robe Universal Interface to the PC and to the DMX input of the fixture.
2. Switch the fixture to the update mode by moving the DIP 12 from the OFF position to the ON position.

Note: The Dip 12 must go from OFF to ON position to switch the fixture to the update mode.

3. Run the Software Uploader program. Select Robe Universal Interface from the COM ports and then click on the Connect button.

4. If the connection is OK, click on the "Start Uploading button" to start uploading. It will take several minutes to perform software update.

If the option "Incremental Update" is not checked, all processors will be updated (including processors with the same software version).

If you wish to update only later version of processors, check the "Incremental Update" box.

Avoid interrupting the process. Update status is displayed in the Info Box window.

When the update is finished, the line with the text "The fixture is successfully updated" will appear in this window.