

ArcSource 1MC tm



Client: _____

Project: _____

Specifier: _____

Type: _____ Qty: _____



FEATURES:

- Input Voltage: 48V DC Via ArcPower Range
- Power consumption: 4.4W
- Light Source: 1 x MC LED
- Delivered Lumen: 126lm 27dg
- Projected LED Life: 60,000 Hrs
- Lumen Output Per Foot: n/a
- Control: DMX Controller
- Housing: Stainless Steel Flange - Brass Hosing
Glass Cover
- Fixing Method: Rubber Seal
- IP Rating: IP68
- Operating Ambient Temp: -20°C/+40°C (-4°F/+104°F)
- Certification: ETL / cETL, CE, RoHS
- 5 Year Warranty

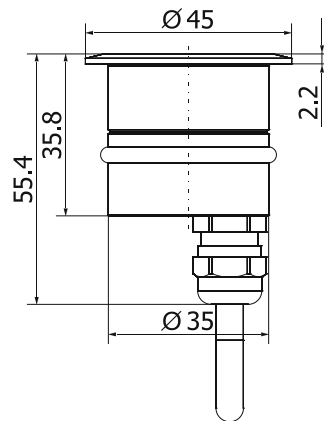

Connection Scheme:

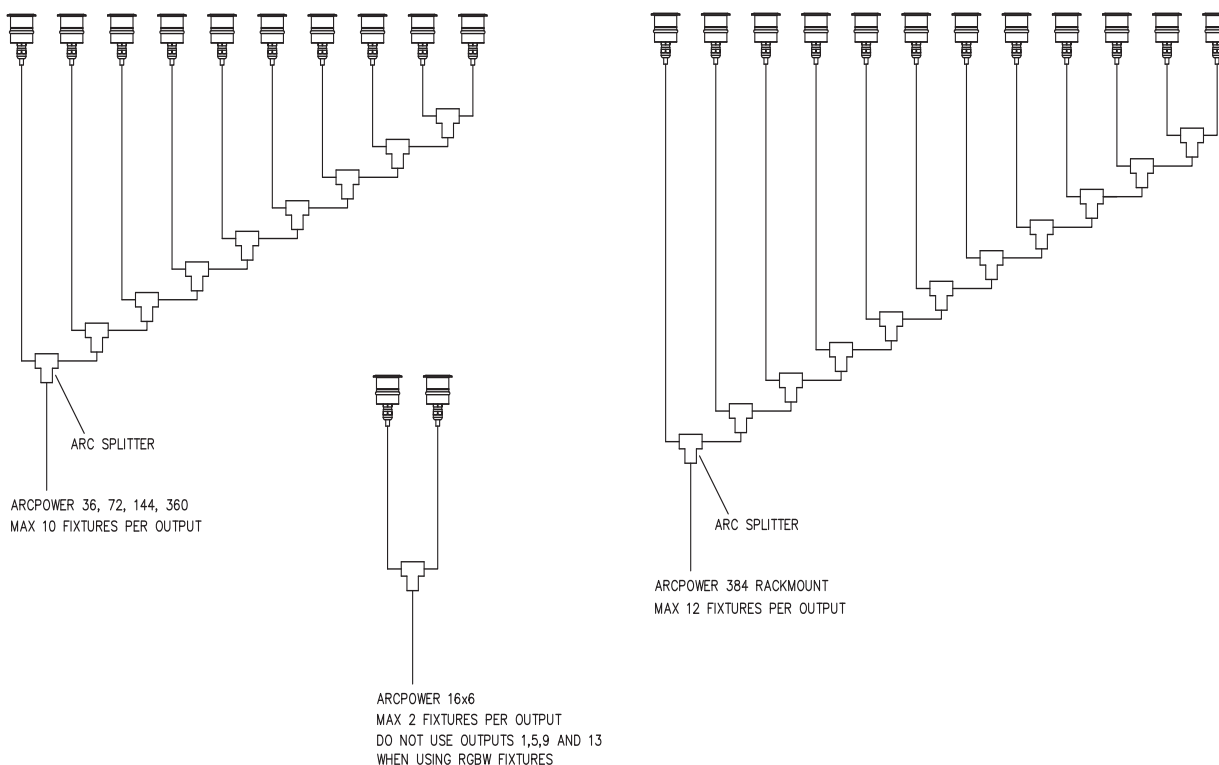

Maximum possible number of LED modules connected to the one LED output of the ArcPower driver is mentioned in the table:

| LED module | LED multichips | Max.number of connected modules | Compatible LED drivers |
|----------------------|----------------|---------------------------------|-------------------------|
| ArcSource 1 MC Short | 1 | 10 | ArcPower 36/72/ 144/360 |
| ArcSource 1 MC Short | 1 | 2 | ArcPower 16x6 |
| ArcSource 1 MC Short | 1 | 12 | ArcPower 384 Rack Mount |

3. Connection ArcSource 1 MC Short

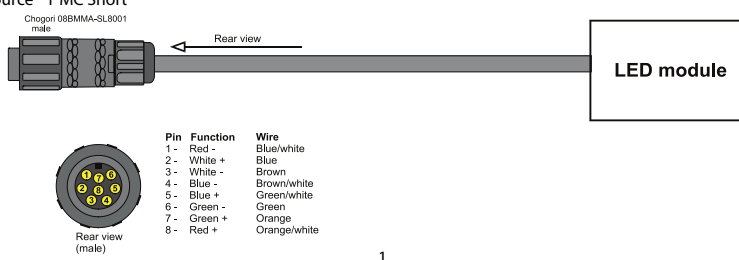

Adapter cable Chogori/ RJ45 between fixture and LED driver

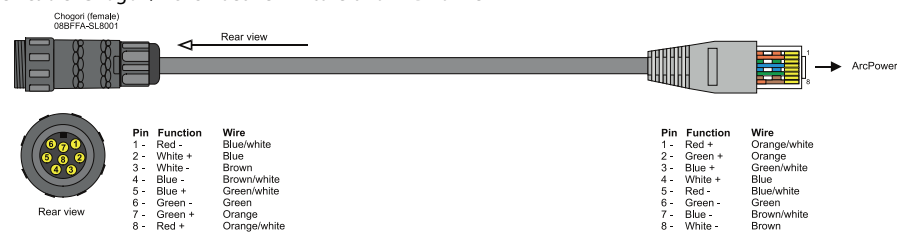

Product Specification:

| | | | |
|-----------------------------|-----------------------------------|--------------------------------|--|
| Electrical | Input Voltage | | 48V DC |
| | Power Consumption | | 4.4W |
| Optical | Light Source | | 1 x 4w Multi-Chip LED |
| | | RGBW | W = 5000-7000K |
| | | SW | 2700-6500K |
| | | PW | 3200K and 6500K |
| | LED Channels | | RGBW, Pure White, Smart White |
| | Beam Angle | | 27°, 35° |
| Projected Lumen Maintenance | | 60,000 hrs (L70@ 25°C / 77°F) | |
| Control | Interface Protocol | | N/A |
| | Wireless DMX (Optional Accessory) | | N/A |
| | Control System | | N/A |
| | Power Supply | | ArcPower Range |
| | Stand Alone Control | | No |
| Physical | Width x Height x Depth | Inches | 2.18 x ø1.77 |
| | | mm | 55.4 x ø45 |
| | Weight | lbs | 0.44 |
| | | kg | 0.2 |
| | Housing | | Stainless Steel Top Flange Brass Housing Tempered Glass |
| | Fixture Cable and Connections | | Igus CF9.03.08 - 0.5m Long (1.64ft) - Chogori IP68 Connector |
| | Fixing Method | | Rubber Seal |
| | Adjustability | | N/A |
| | IP Rating | | IP68 |
| | IK Rating | | IK** |
| | Cooling System | | Convection |
| | Operating Ambient Temperature | | -20°C / +40°C (-4°F / +104°C) |
| Operating Temperature | | TBC | |
| Certification | Listings | ETL / cETL, CE, RoHS | |

Subject to change without notice - please contact Anolis for clarification

| Accessories | Description |
|-------------|--|
| | Splitter 1pcs (See Splitter Technical Guide) (Included) |
| | Connector Chogori CGRBDU-08BFFA (Female) IP68 (Included) |
| | Connector Chogori CGRBDU-08BMMA (Male) IP68 |
| | Connector Chogori T Piece |
| | Connector Waterproof Cap (Male) |
| | Cable Chogori (Female) - RJ45 3m |
| | Cable Chogori (Female) - RJ45 7m |
| | Cable Chogori (Female) - RJ45 15m |
| | Cable Chogori (Female) - RJ45 20m |
| | <i>other lengths on request</i> |

Photometric Data:

For foot Candles divide lux by 10.7

ArcSource 1MC - 27dg

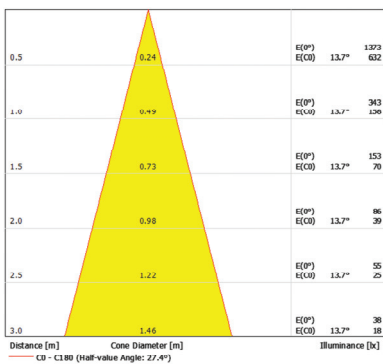
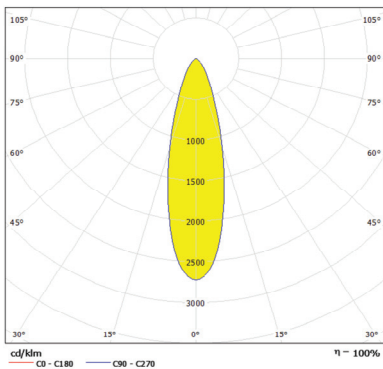

Total Luminous Flux: 126lm