

## Divine™ 160



Client: \_\_\_\_\_

Project: \_\_\_\_\_

Specifier: \_\_\_\_\_

Type: \_\_\_\_\_ QTY: \_\_\_\_\_

### FEATURES:

- Input Voltage: 100 - 277 V AC 50/60 Hz
- Power Consumption: 440 W +/- 10%
- Light Source: 40 x Multi Chip LED's
- Delivered Lumen: 11.836 lm (RGBW @13°)
- Projected LED life: 60.000 Hrs (L70@25 °C / 77 °F)
- Control: DMC Controller
- IP Rating: IP67
- 5 Years Warranty

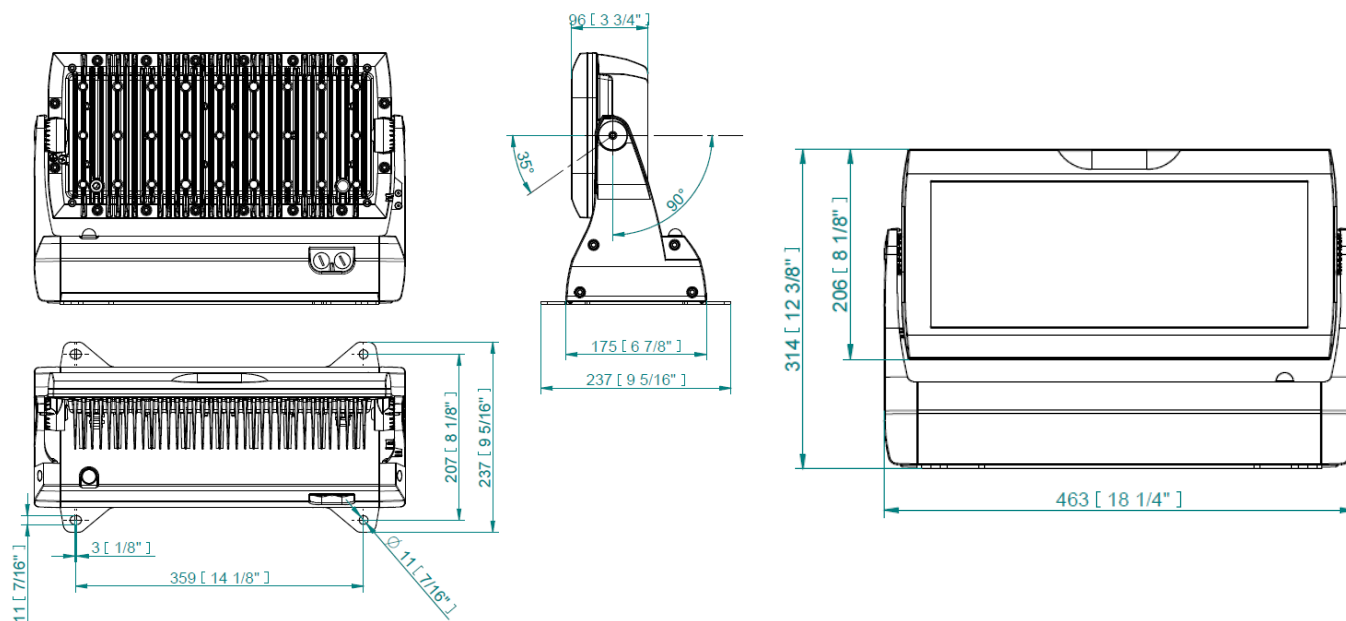
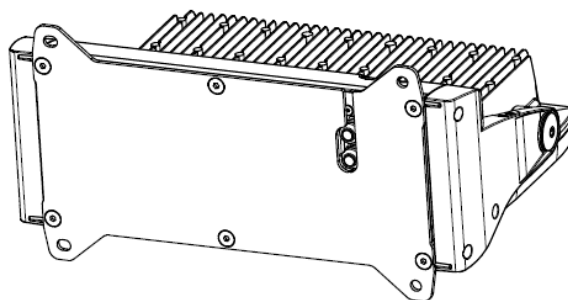

## Specification:

ELECTRICAL	Input Voltage	100 - 277 V AC 50/60 Hz
	Typical Power Consumption	440 W +/- 10 %
	Inrush Current	30 A @ 230 V, 20 A @ 115V
OPTICAL	Light Source	40 x High Power Multichip LEDs
	Colour Variants	RGBW (W - 6500 K), RGBA, PW (W - 3000 K)
		Other Variants On Request
	Beam Angle	13°, 25°, 35°, 45°, 65°, 100°, 15° x 35°, 35° x 15°, 15° x 65°, 65° x 15°, 20° x 45°, 45° x 20°, 35° x 70°, 70° x 35°, 35° x 90°, 90° x 35°, 20° x 90°, 90° x 20°
	Lumen Output Delivered	11.836 lm (RGBW 13°, all LEDs on full)
Projected Lumen Maintenance	60.000 hrs (L70 @ 77 °F / 25 °C)	
CONTROL	Display	LED Display (Inside Integrated Junction Box)
		Chassis Mounted LED Display (Optional)
	Wireless DMX	Lumen Radio CRMX Technology (Optional)
	Interface Protocol	USITT DMX512, RDM
	Control System	Third Party DMX Controllers
	Operating Modes	DMX, Stand-alone
	DMX Modes	4
	DMX Channels	10, 22, 5, 4
	Programs / Functions / Features	Editable Program: 1 (up to 40 steps)
	Settings / Addressing	Via LED Display with Control Buttons or RDM
Power Supply	Integrated	
PHYSICAL	Width x Height x Depth	463 x 314 x 175 / 237 mm (18.2 x 12.4 x 6.9 / 9.3 in.)
	Weight	14.5 kg / 32 lbs
	Housing	High Pressure Die-Cast Aluminium Body
		Tempered Glass
	Finish Options	Standard Colour - Graphite Black (RAL 9011), Silver (RAL 9006)
		Cost Option - Custom RAL
	Cables / Connections	Integrated Junction Box With Terminal Block
		Recommended: Li9Y11Y 3 x AWG16 + 1(2 x AWG24)
	Mounting Method	Surface Mount, Flush (J-Box), C-Clamp (For Side Connection Only)
	Adjustability	+35° / -90°
	Protection Factor	IP67 / Suitable For Wet Locations
IK Rating	IK10	
Cooling System	Convection	

PHYSICAL	Operating Ambient Temperature	-20 °C / +40 °C (-4 °F / +104 °F)
	Operating Temperature	+75 °C @ Ambient +40 °C (+167 °F @ Ambient +104 °F)
	Total Heat Dissipation	1500 BTU/h (calculated)
CERTIFICATION	Listings	ETL / cETL, CE, RoHS

ACCESSORIES		Surface Mount Adaptor (Included)
		Optical Demo Set for Divine 160
		Top Hat Divine 160
		Half Top Hat Divine 160
		Barn Door Module Divine 160
		Wire Guard/Anti-Glare Divine 160
		Set of Rubber Feet
		C-Clamp Adaptor Divine (for side conn. only)
		Single Top Loader Case Divine

## Connection:

- Unscrew the eight screws (2) on the terminal block cover (1) to get access to the terminal block and control display (6) with four control buttons (7).
- Unscrew both cable glands (4) from the terminal block cover (1) and both blind flanges (10) from the fixture base.
- Apply an adequate layer of the paste LOCTITE 5331 on the plastic holder of the cable gland before inserting it into the body of the gland. Apply an adequate layer of the paste LOCTITE 577 on the thread of the gland body. Screw both cable glands (4) back into the terminal block cover (1) - see the picture below.
- Apply an adequate layer of the paste LOCTITE 577 on the thread of the blind flange. Screw both blind flanges (10) back into the fixture base.
- Pass the power/data cable through one cable gland (4) and connect to the terminal block.
- Remove end cap (3) from cable glands before passing cable into the terminal block compartment. The two cable glands serve for cables of diameter of 5-10 mm.  
To keep declared IP rating, every cable gland has to be covered with an end cap (3) if the cable gland is not used for cable passing.
- After connecting cables and setting the fixture by means of the control display and four buttons, place the cover (1) on the terminal block back, make sure the seal (5) is inserted correctly.
- Screw the terminal block cover (1) with eight screws using a tightening torque of 7Nm.
- Check that all cable glands and screws and blind flanges are firmly secured.

Cable gland M20

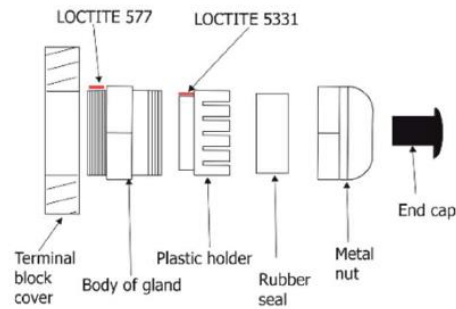

Blind flange



Cable glands M20

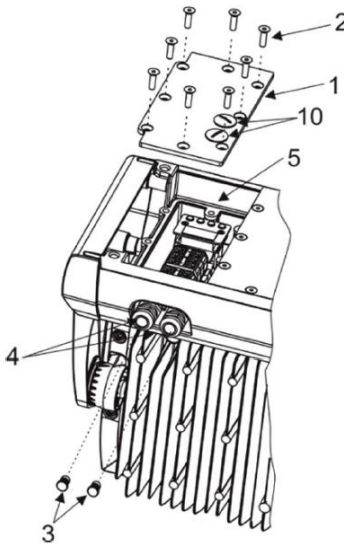
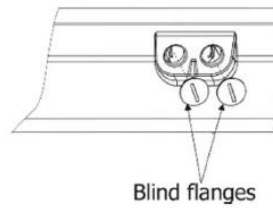
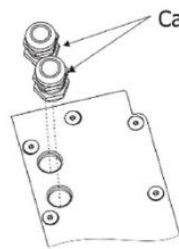

Side connection

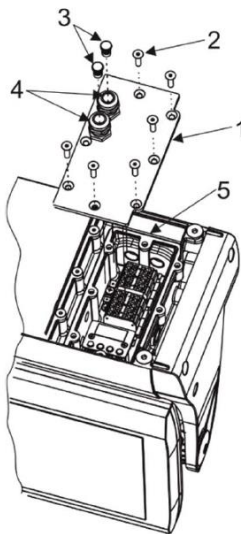

Rear connection

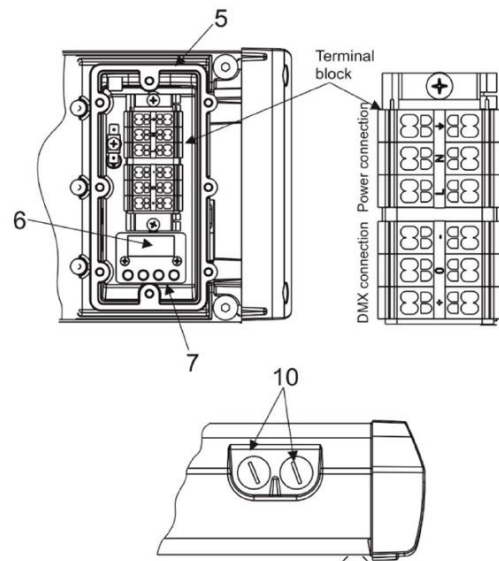

## Labels:

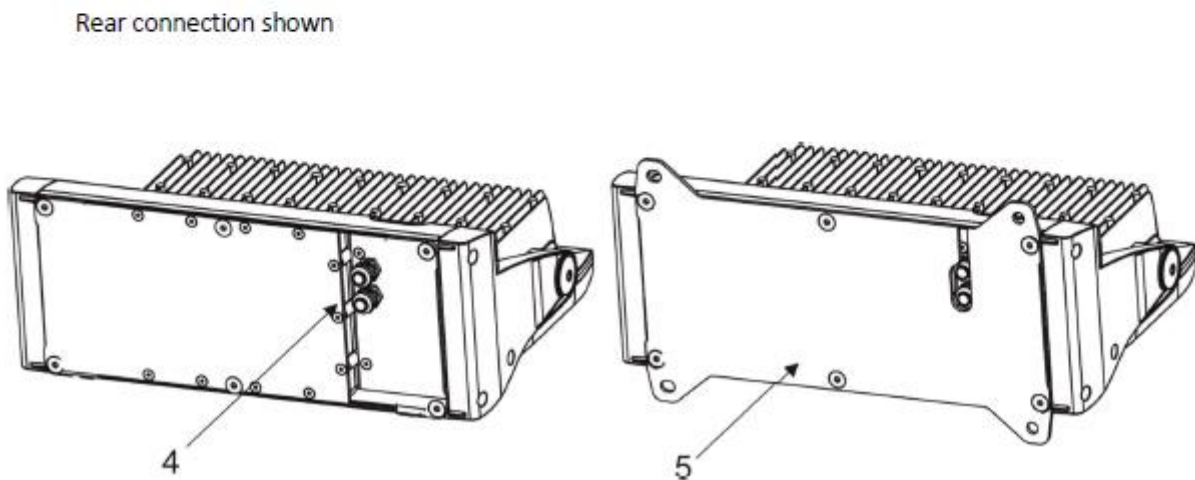
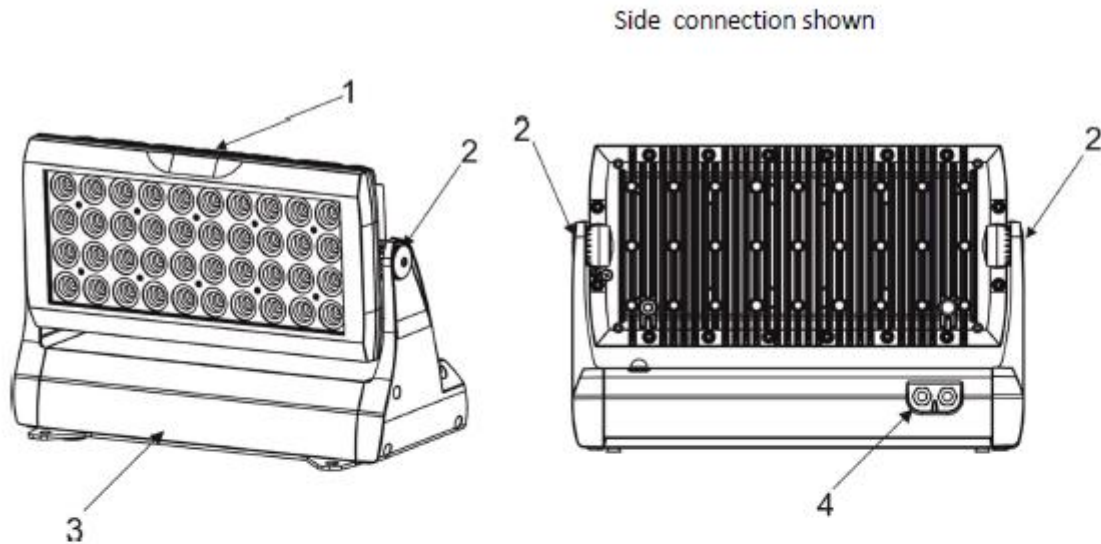

1. Head with LED array
2. Tilt lock
3. Base
4. Cable glands or blind flange (depends on fixture version)
5. Surface Mounting adapter

Note: Customer can interchange the cable glands and blind flanges in the fixture base to create a side or rear connection

## Photometric overview

Beam Angle	Lumen Output (lm)		
	RGBW	RGBA	WW (3000 K)
13°	11 836	7 697	9 673
25°	10 903	7 090	8 910
35°	10 882	7 076	8 893
45°	10 876	7 072	8 888
65°	10 842	7 050	8 860
100°	10 514	6 837	8 592
15° x 35°, 35° x 15°	10 628	6 911	8 685
15° x 65°, 65° x 15°	11 017	7 164	9 003
20° x 45°, 45° x 20°	10 981	7 141	8 974
35° x 70°, 70° x 35°	10 912	7 096	8 918
35° x 95°, 95° x 35°	10 495	6 825	8 577
20° x 90°, 90° x 20°	11 022	7 167	9 007