

# LAMARI™ 0.5 / 1 / 2 / 3 / 4 SC

Our linear LED fixture is the ideal choice for professional lighting, offering outstanding color mixing. For enhanced safety, the fixture operates at 48V and is controlled via DALI 2 and E-Box Remote series controllers. The fixture's body is made from durable aluminum, boasting IK10 and IP67 ratings, ensuring high resistance to mechanical damage and harsh weather conditions. A wide range of beam angles is available, allowing precise adjustment to meet specific project requirements. The fixture is available in four length variants and offers multiple surface mounting options.



## KEY FEATURES

### Optic & Control

Advanced technology ensures precise blending of colours. Choose from a variety of beam angles to suit different lighting needs. 48V operation for safe usage in various environments.

### Compact design

At only 39 mm of total height, Lamari SC has been designed as a compact and slim LED luminaire suitable for any low-profile application. Available in four length options with multiple mounting configurations.

### Durability

Thanks to its tempered glass and high-pressure, extruded aluminum housing, Lamari SC is IK10 and IP67 certified. For more extreme and marine applications, a harsh environment finish option is also available.

## CONTROL & PROTOCOLS



## STANDARD & SPECIFICATION



## FINISH OPTIONS

\* CLOSEST RAL TONE  
\* HE = Harsh Environment



Custom  
Paint  
Colour

## COLOURS

### STANDARD



PW  
(3000 K)



TW  
(2200-3000 K)

### UPON REQUEST

AVAILABLE COLOURS  
FOR CUSTOM SETUP



2.200 K



2.700 K



4.000 K



6.500 K

## OPTIC OPTIONS

### SYMMETRICAL



12°



15°



25°



35°



50°



70°



105°

### BI-SYMMETRICAL



10°x20°



10°x40°



10°x80°



15°x45°



15°x90°



40°x90°



35°x110°

**SPECIFICATION**

<b>ELECTRICAL</b>	Input Voltage	48 V			
	Typical Power Consumption	<b>Lamari SC 0.5:</b> 5 W	<b>Lamari SC 1:</b> 10 W		
		<b>Lamari SC 2:</b> 20 W	<b>Lamari SC 3:</b> 30 W		
	<b>Lamari SC 4:</b> 40 W				
<b>OPTICAL</b>	Light Source	<b>Lamari SC 0.5 / 1 / 2 / 3 / 4:</b> 4 / 8 / 16 / 24 / 32 High Power LEDs			
	Colour Variants	Pure White (W - 3000 K)   Tuneable White (2200–3000 K)			
		<b>Custom Setup On Request:</b> 2200 K, 2700 K, 4000 K, 6500 K			
	Beam Angle	Without Linear Louvre	Symmetrical:	12°   15°   25°   35°   50°   70°   105°	
			Bi-symmetrical:	10°x20°   10°x40°   10°x80°   15°x45°   15°x90°   35°x110°   45°x65°	
		With Linear Louvre <small>*Low Glare Accessories</small>	Symmetrical:	12°   15°   25°	
			Bi-symmetrical:	10°x20°   10°x40°   10°x80°   15°x45°   15°x90°   35°x110°	
	Lumen Output Delivered	<b>Lamari SC 0.5:</b> 296 lm, (SC, PW 2700K) <b>TBC</b>		<b>Lamari SC 1:</b> 591 lm, (SC, PW 2700K) <b>TBC</b>	
		<b>Lamari SC 2:</b> 1274 lm, (SC, TW @3000K) <b>TBC</b>		<b>Lamari SC 3:</b> 1911 lm, (SC, TW @3000K) <b>TBC</b>	
		<b>Lamari SC 4:</b> 2548 lm, (SC, TW @3000K) <b>TBC</b>			
Projected Lumen Maintenance	L90B10 >90.000 hrs, Ta = 25°C / 77°F				
<b>CONTROL</b>	Interface Protocol	Via E-Box Remote range, DALI 2			
	E-Box Remote Control Protocols	USITT DMX512, RDM, ArtNet, MA Net, MA Net2, sACN, Kling-Net			
	Operating Modes	Pixel (per 1/2 Foot) or Fixture mode			
	Setting / Addressing	Via Two Row LCD Display with Control Buttons on E-Box Remote or RDM communicator			
	Power Supply	Via E-Box Remote range			
	Connectivity	E-box Remote   E-box Remote Basic			
<b>PHYSICAL</b>	Width x Height x Length		Rear:	Side:	
		<b>Lamari SC 0.5</b>	37 x 39 x 185 mm (1.46 x 1.54 x 7.28 in.)	37 x 39 x 185 mm (1.46 x 1.54 x 7.28 in.)	
		<b>Lamari SC 1</b>	37 x 39 x 339 mm (1.46 x 1.54 x 13.4 in.)	37 x 39 x 339 mm (1.46 x 1.54 x 13.4 in.)	
		<b>Lamari SC 2</b>	37 x 39 x 647 mm (1.46 x 1.54 x 25.5 in.)	37 x 39 x 647 mm (1.46 x 1.54 x 25.5 in.)	
		<b>Lamari SC 3</b>	37 x 39 x 956 mm (1.46 x 1.54 x 37.6 in.)	37 x 39 x 956 mm (1.46 x 1.54 x 37.6 in.)	
		<b>Lamari SC 4</b>	37 x 39 x 1264 mm (1.46 x 1.54 x 49.8 in.)	37 x 39 x 1264 mm (1.46 x 1.54 x 49.8 in.)	
	Weight 0.5 / 1 / 2 / 3 / 4	0.5 kg (1.1 lbs) / 0.9 kg (2.0 lbs) / 1.6 kg (3.5 lbs) / 2.2 kg (4.9 lbs) / 2.8 kg (6.2 lbs)			
	Housing	High Pressure Extruded Aluminium Body   End Caps – Die-Cast Aluminium   Tempered Glass			
	Finish Options	Standard Colour	Graphite Black RAL 9011*   Grey Aluminium RAL 9007 Pure White RAL 9010   Sandstone RAL 1014* <small>*Closest RAL Tone</small>		
		Standard Colour Harsh Environment	Graphite Black RAL 9011*   Grey Aluminium RAL 9007 Pure White RAL 9010   Sandstone RAL 1014* <small>*Closest RAL Tone</small>		
Cost Option		Custom RAL			
Cables/Connections	IP67 Hybrid Connection (Power + Data)				
Mounting Method	Surface Mount With Different Type of Brackets				
Adjustability	+10° (With Standard Mounting Bracket)				
Protection Factor   IK Rating	IP67 / Suitable For Wet Locations   IK10				
Cooling System	Convection				
Operating Ambient Temperature	-20°C / +40°C (-4°F / +104°F)				
Operating Temperature	+67°C @ Ambient +40°C (+153°F @ Ambient +104°F)				
<b>CERTIFICATION</b>	Listings	ETL / cETL, CE, RoHS, UKCA			

**SPECIFICATION**

<b>CABLES AND CONNECTORS</b>	Leader Cable FF, 0.1 m, CE AD-05
	Jumper Cable MM/FF CE AD-05, 0.5 m   1 m   3 m   5 m
	T-connector FMF CE AB-AD-05
	Cable SJTW 5x14 AWG black
	Cable SJTW 5x14 AWG white
	Field Installable Connector FF DC-05 (for 5x14 AWG)
	Field Installable Connector FM DC-05 (for 5x14 AWG)
	Connection Box Remote 1xOut
	Connection Box Remote 2xOut

**LAMARI INPUT OPTIONS**

STANDARD

UPON REQUEST

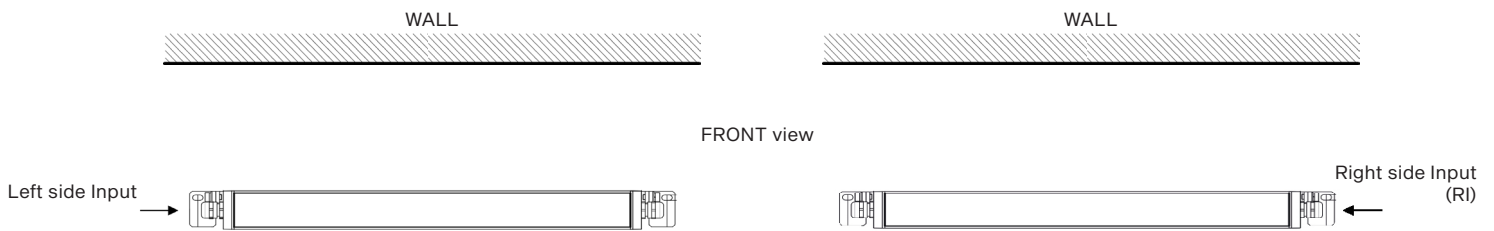

**DISTANCE FROM THE WALL**

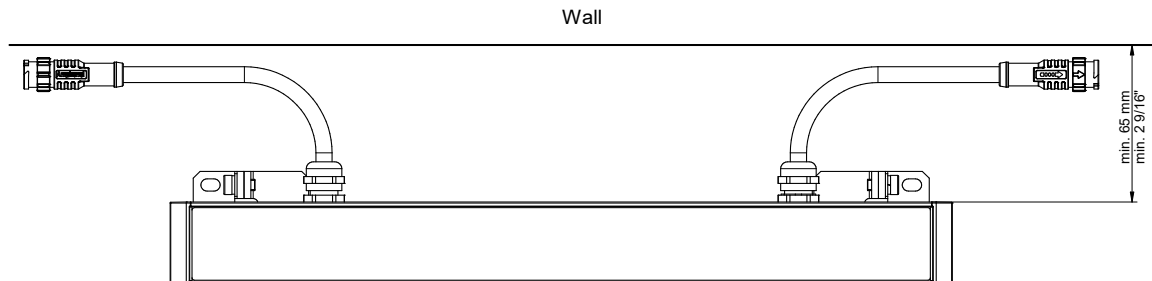

**CONTROL AND CONNECTION OPTIONS**

**STANDARD**

- 1) Leader Cable FF, 0.1 m, CE AD-05 (I3053978)
- 2) Cable 5x20 AWG, 0.5 m, with connector MM
- 3) Cable 5x20 AWG, 0.1 m, with connector FF

E-Box Remote /  
Remote Basic /  
Remote Basic Mini

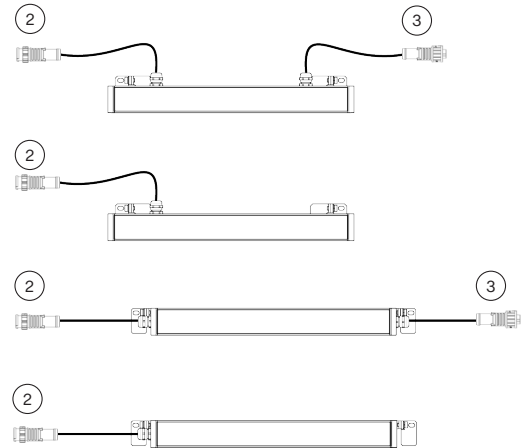
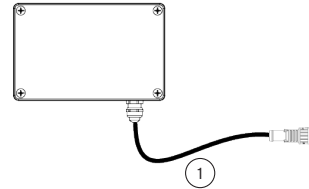

**Note: The last unplugged connector must be fitted with a Waterproof Cap to protect the IP rating.**

**STANDARD WITH JUMPER CABLE**

- 1) Leader Cable FF, 0.1 m, CE AD-05 (I3053978)
- 2) Cable 5x20 AWG, 0.5 m, with connector MM
- 3) Cable 5x20 AWG, 0.1 m, with connector FF
- 4) Jumper Cable MM/FF - 0.5 m | 1 m | 3 m | 5 m

E-Box Remote /  
Remote Basic /  
Remote Basic Mini

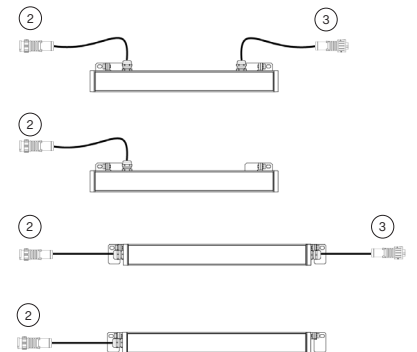
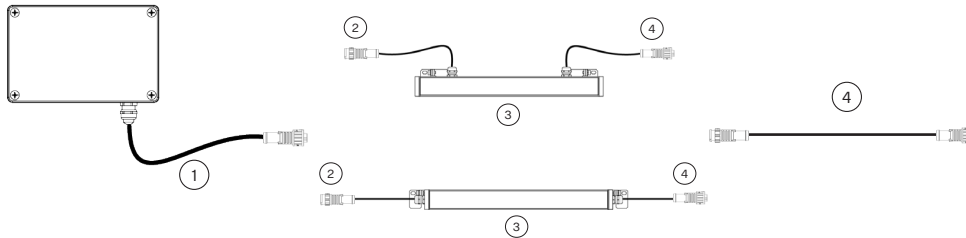

**Note: The last unplugged connector must be fitted with a Waterproof Cap to protect the IP rating.**

**DALI VERSION (CE)**

- 1) Junction Box Remote with 5x20 AWG, 0.1 m, with connector FF
- 2) Cable 5x20 AWG, 0.5 m, with connector MM
- 3) Cable 5x20 AWG, 0.1 m, with connector FF

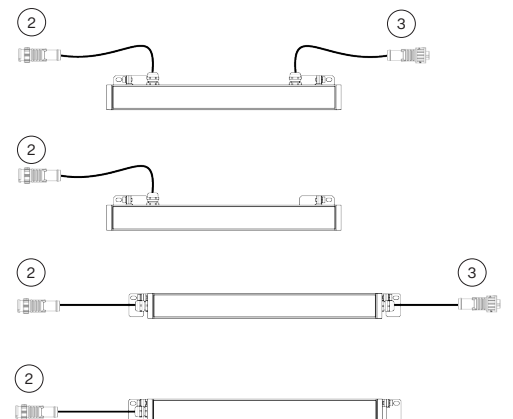
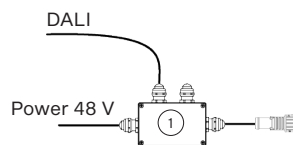

**Note: The last unplugged connector must be fitted with a Waterproof Cap to protect the IP rating.**

**CONTROL AND CONNECTION OPTIONS**

**DMX WITH CONNECTION BOX FOR LAMARI**

**A**

- 1) SJTW 5x14 AWG (13053336), standard with bare-end, black or Cable SJTW 5x14 AWG (13053697), with bare-end, white (on request)
- 2) Field Installable Connector FF DC-05 (13053971)
- 3) Connection Box Remote 1x Out (14 AWG–20 AWG), Cable 5x20 AWG, 0.1 m, with connector FF
- 4) T-connector FMF (13053941)
- 5) Cable 5x20 AWG, 0.5 m, with connector MM
- 6) Cable 5x20 AWG, 0.1 m, with connector FF

**Note: The last unmated connector must be fitted with an Waterproof Cap to protect the IP rating.**

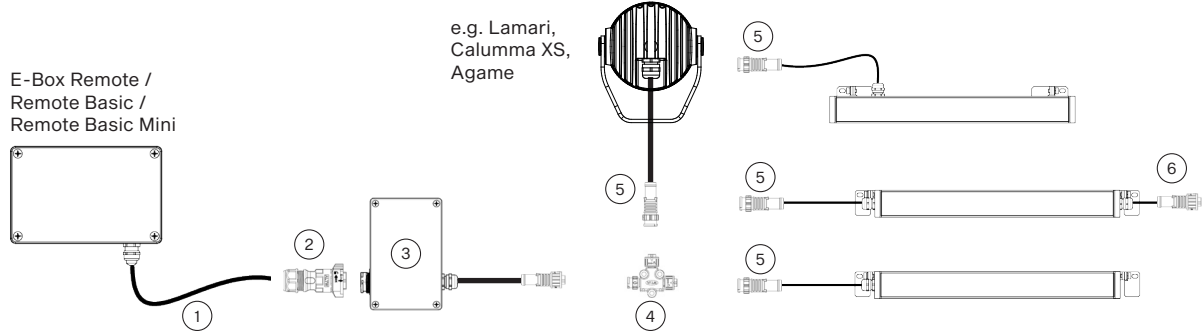

**B**

- 1) SJTW 5x14AWG (13053336), standard with bare-end, black or Cable SJTW 5x14AWG (13053697), with bare-end, white (on request)
- 2) Field Installable Connector FF DC-05 (13053971)
- 3) Connection Box Remote 2x Out (14 AWG–14 AWG & 20 AWG), Cable 5x20 AWG, 0.1 m, with connector FF
- 4) Cable 5x20 AWG, 0.1 m, with connector FF
- 5) Field Installable Connector FM DC-05 (13053973)
- 6) Cable 5x20 AWG, 0.5 m, with connector MM

**Note: The last unmated connector must be fitted with an Waterproof Cap to protect the IP rating.**

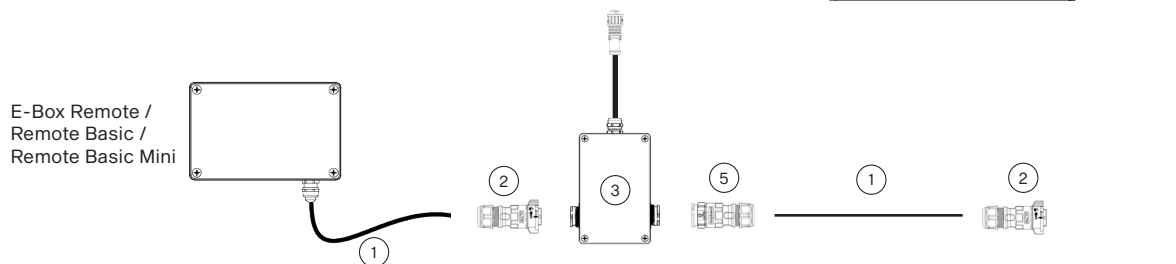

LAMARI CABLE ENTRY OPTIONS

Rear IN/OUT Version



Rear IN Version



Side IN/OUT Version



Side IN Version



**DIMENSIONS**

**Rear IN/OUT Version**

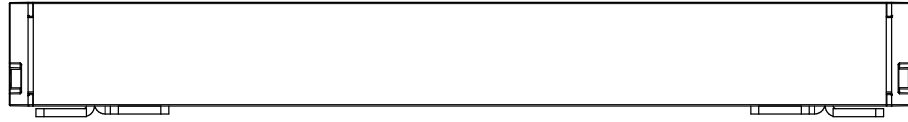
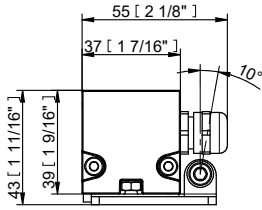

Wall

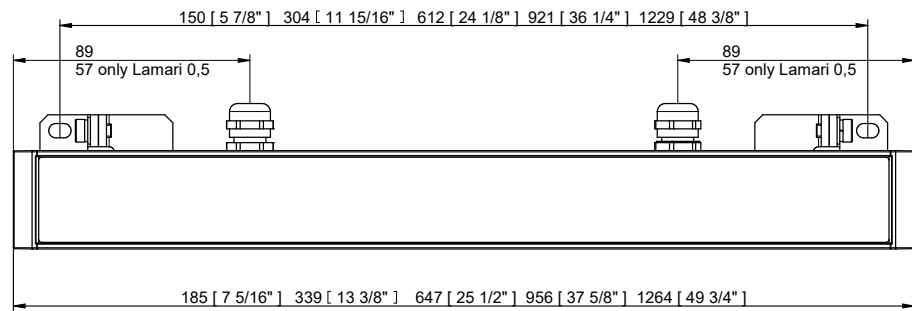

**Rear IN Version**

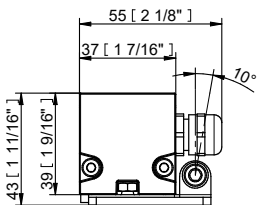

Wall

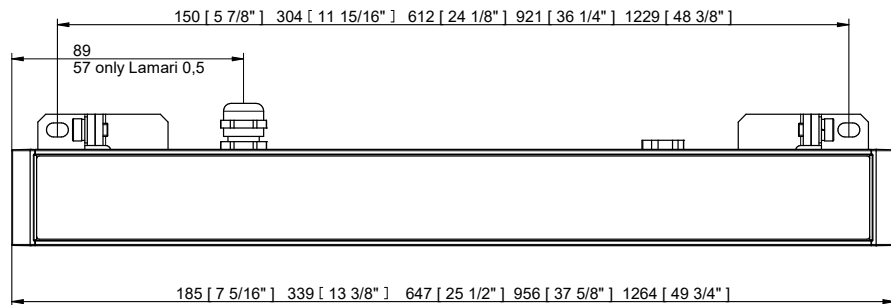

Side IN/OUT Version

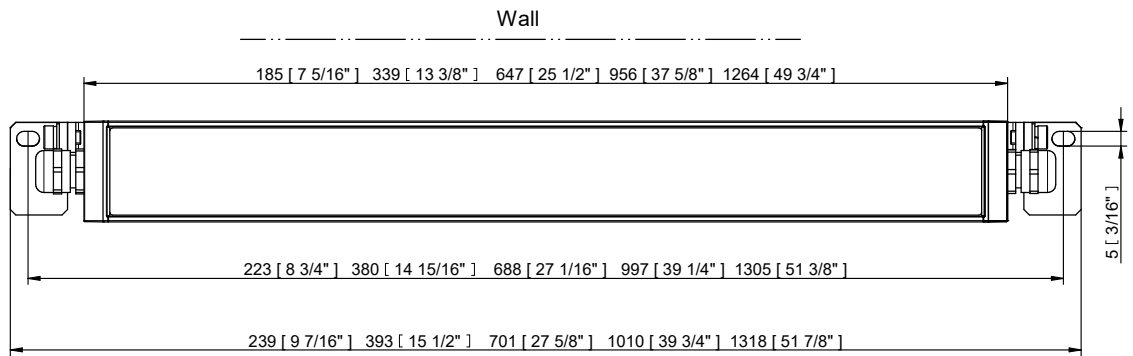
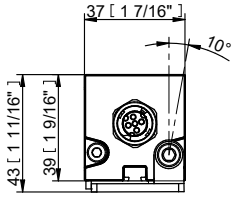

Side IN Version

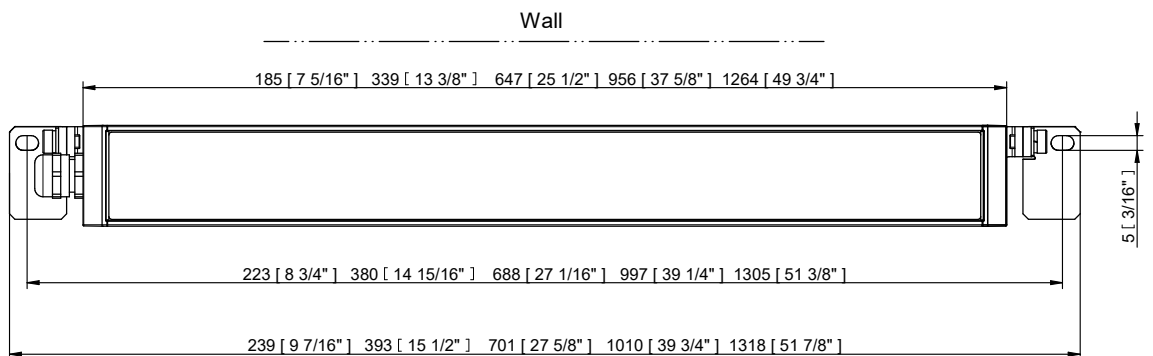
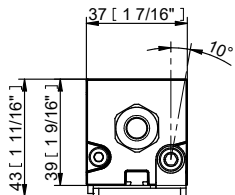

**ACCESSORIES**

**Barndoors for Lamari Side**

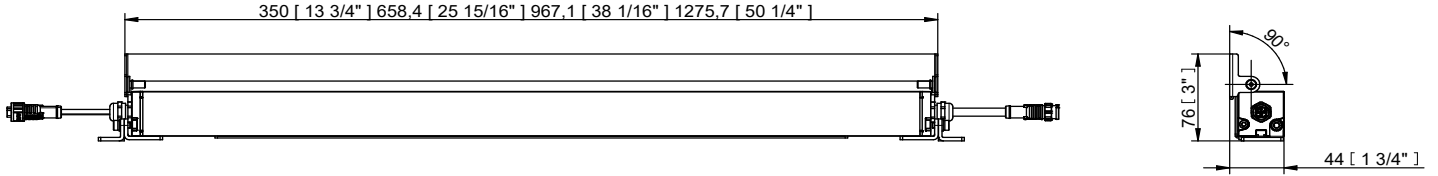

**Barndoors for Lamari Rear**

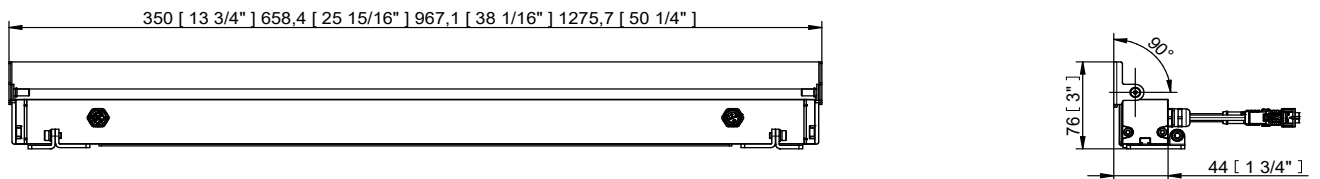

**Shields for Lamari Side**

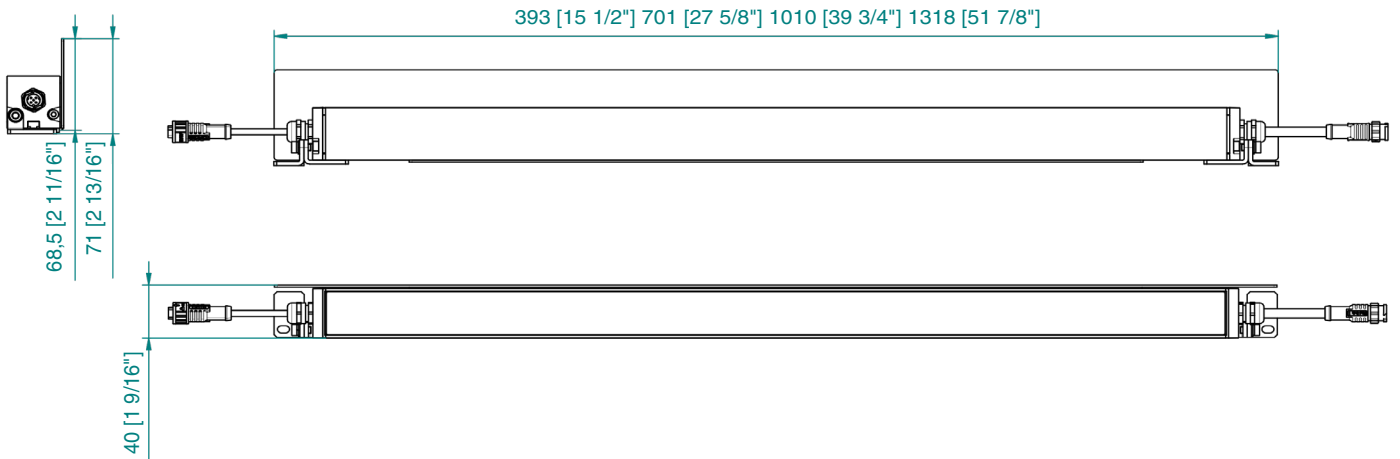

**Shields for Lamari Rear**

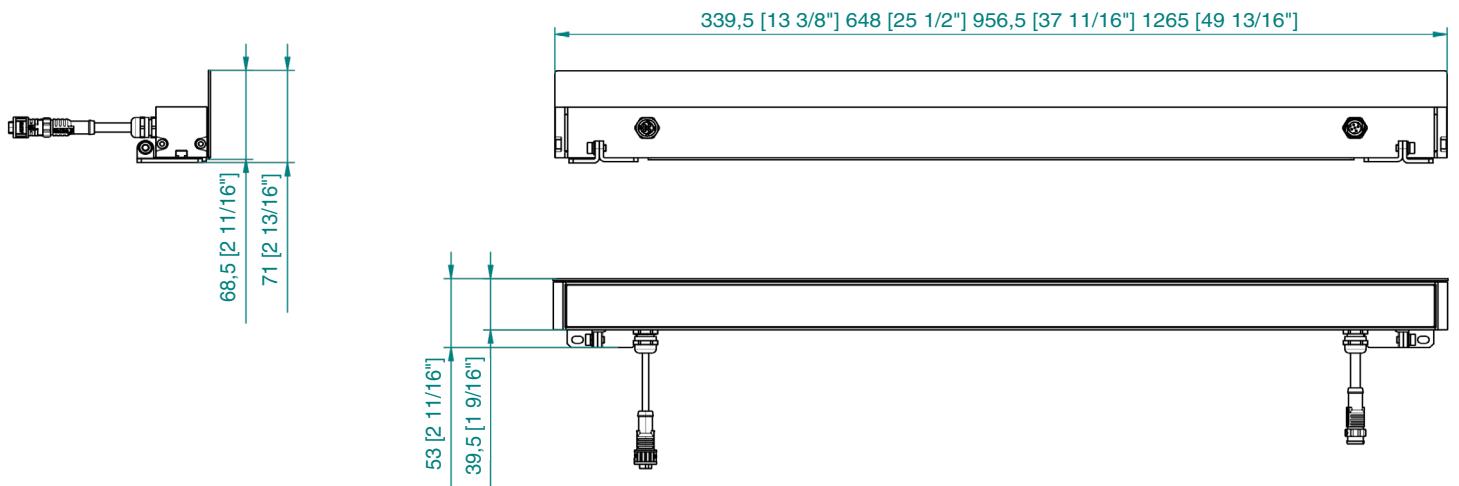

Wall Mount Brackets

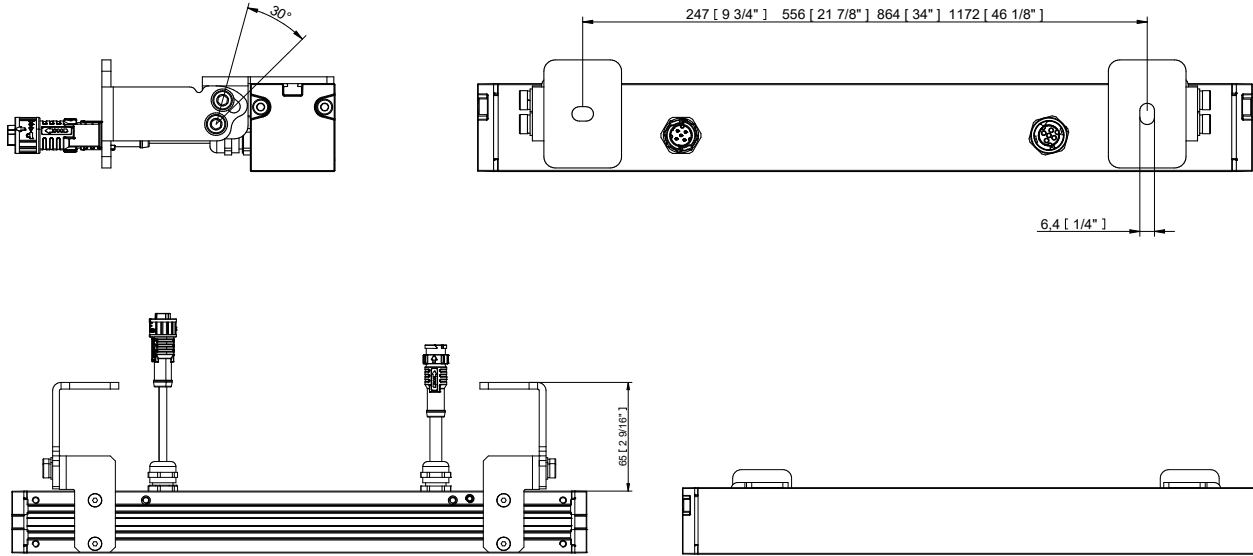

Wall Mount Scissors Brackets

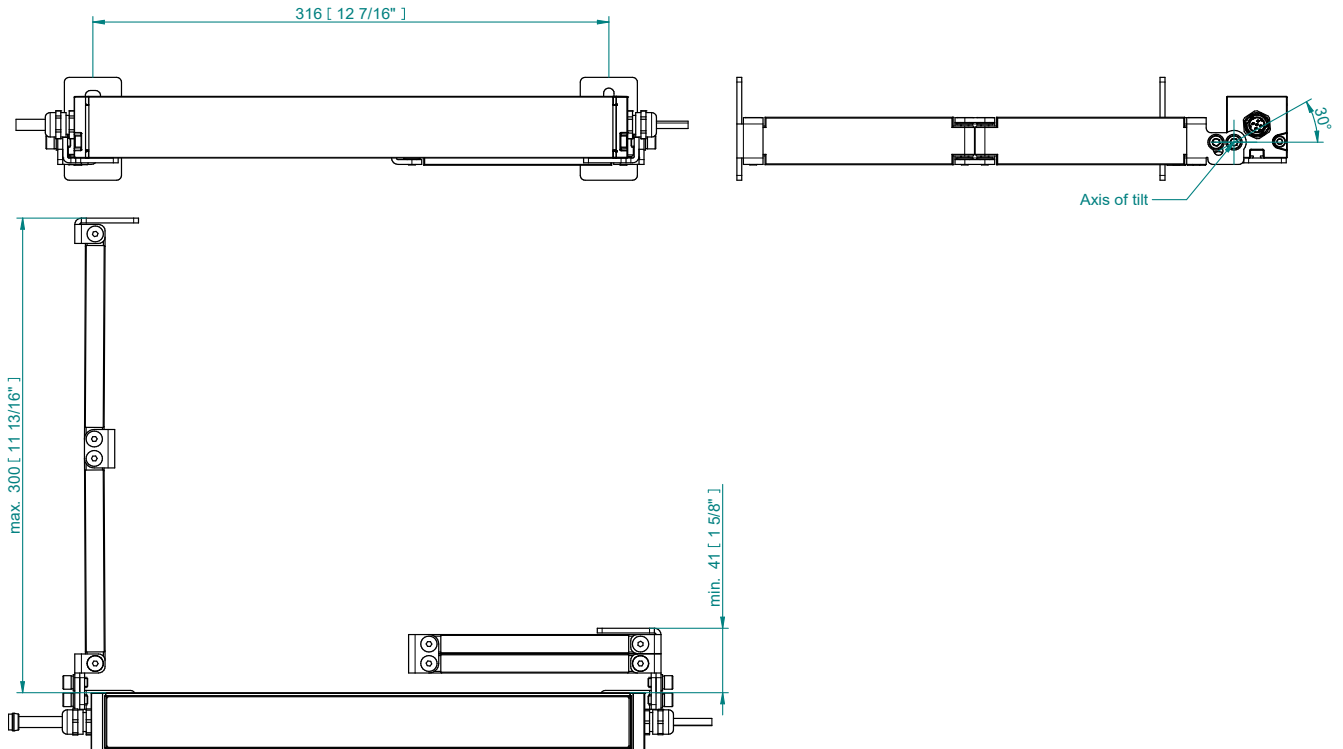

**BI-SYMMETRICAL BEAM ANGLES**

Bi-symmetrical: 15°x40°, 15°x70°, 20°x45°, 20°x80°, 35°x110°, 40°x65°

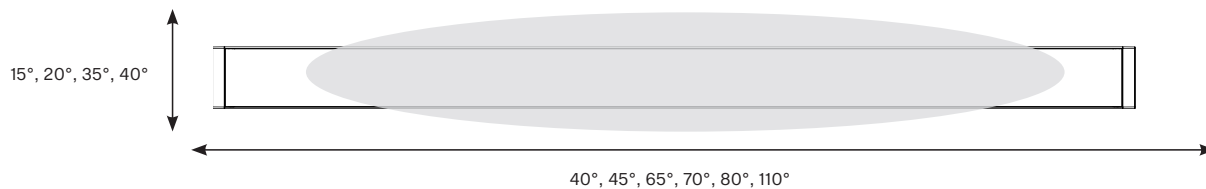

PHOTOMETRIC DATA

Lamari SC 4 TW (2200K–3000K)  
12dg set to 3000K

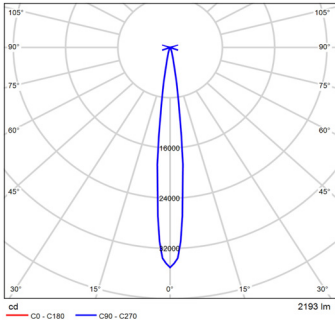

Lamari SC 4 TW (2200K–3000K)  
15dg set to 3000K

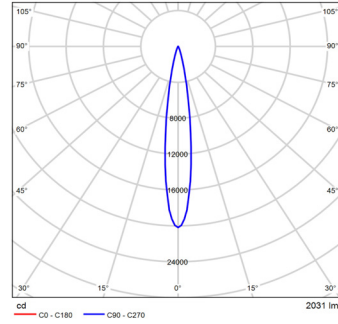

Lamari SC 4 TW (2200K–3000K)  
25dg set to 3000K

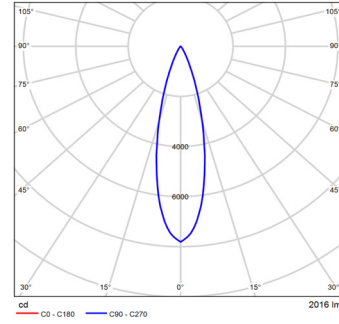

Lamari SC 4 TW (2200K–3000K)  
35dg set to 3000K

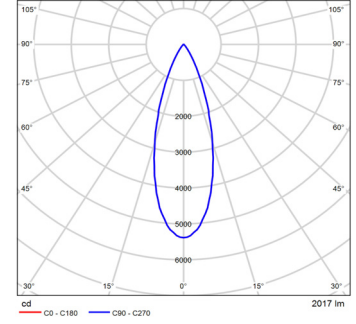

Lamari SC 4 TW (2200K–3000K)  
50dg set to 3000K

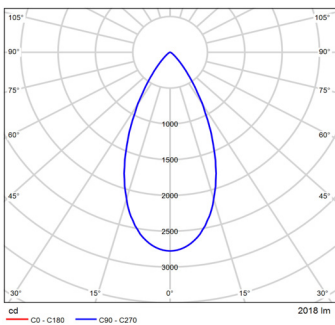

Lamari SC 4 TW (2200K–3000K)  
70dg set to 3000K

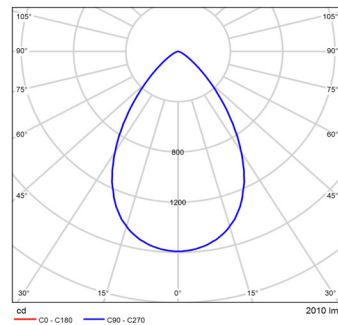

Lamari SC 4 TW (2200K–3000K)  
105dg set to 3000K

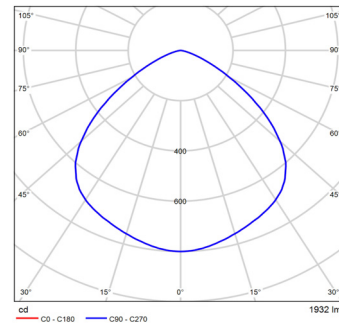

Lamari SC 4 TW (2200K–3000K)  
10dg x 20dg set to 3000K

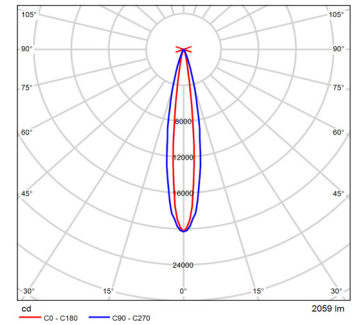

Lamari SC 4 TW (2200K–3000K)  
10dg x 40dg set to 3000K

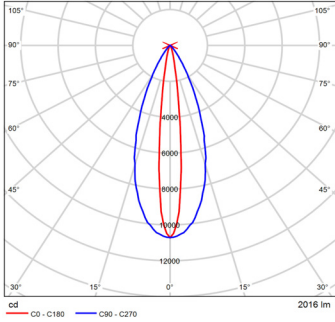

Distance [m]	Cone diameter [m]	Beam angle [°]	E(0°) [lx]	E(C90) [lx]	E(C180) [lx]
0.50	0.35 0.11	12.0°	42816	17853	21438
1.0	0.72 0.21	12.0°	10708	4463	5360
1.5	1.1 0.32	12.0°	4768	1984	2382
2.0	1.4 0.42	12.0°	2676	1116	1340
2.5	1.8 0.53	12.0°	1713	714	869
3.0	2.2 0.63	12.0°	1189	486	588

Lamari SC 4 TW (2200K–3000K)  
10dg x 80dg set to 3000K

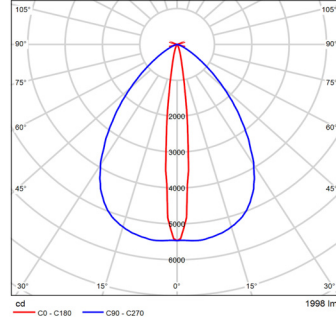

Distance [m]	Cone diameter [m]	Beam angle [°]	E(0°) [lx]	E(C90) [lx]	E(C180) [lx]
0.50	0.81 0.11	77.8°	2189	828	1045
1.0	1.6 0.21	77.8°	548	323	411
1.5	2.4 0.32	77.8°	243	159	206
2.0	3.2 0.43	77.8°	136	86	110
2.5	4.0 0.53	77.8°	87	54	70
3.0	4.8 0.64	77.8°	67	41	53

Lamari SC 4 TW (2200K–3000K)  
15dg x 45dg set to 3000K

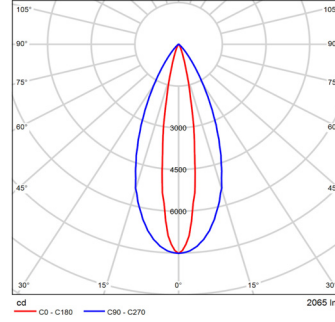

Distance [m]	Cone diameter [m]	Beam angle [°]	E(0°) [lx]	E(C90) [lx]	E(C180) [lx]
0.50	0.85 0.15	16.4°	3051	1292	1614
1.0	1.6 0.29	16.4°	761	303	389
1.5	2.4 0.44	16.4°	339	134	173
2.0	3.2 0.58	16.4°	187	75	95
2.5	4.0 0.73	16.4°	120	48	61
3.0	4.8 0.88	16.4°	85	36	46

Lamari SC 4 TW (2200K–3000K)  
15dg x 90dg set to 3000K

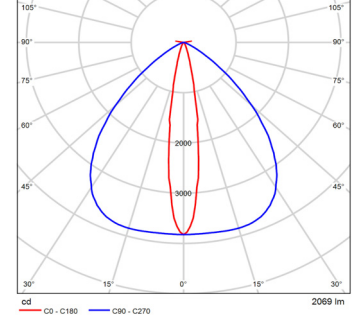

Distance [m]	Cone diameter [m]	Beam angle [°]	E(0°) [lx]	E(C90) [lx]	E(C180) [lx]
0.50	1.0 0.14	43.4°	1596	622	785
1.0	2.0 0.29	43.4°	394	155	196
1.5	3.0 0.43	43.4°	263	103	131
2.0	4.0 0.58	43.4°	196	77	98
2.5	5.0 0.72	43.4°	156	61	78
3.0	6.0 0.86	43.4°	128	50	63

Lamari SC 4 TW (2200K–3000K)  
35dg x 110dg set to 3000K

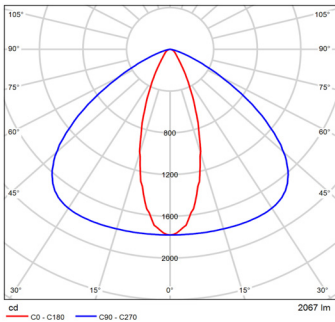

Distance [m]	Cone diameter [m]	Beam angle [°]	E(0°) [lx]	E(C90) [lx]	E(C180) [lx]
0.50	1.4 0.32	55.2°	7116	272	3396
1.0	2.9 0.63	55.2°	1779	136	1716
1.5	4.3 0.95	55.2°	791	75	944
2.0	5.8 1.3	55.2°	445	42	519
2.5	7.2 1.6	55.2°	285	27	341
3.0	8.6 1.9	55.2°	198	19	243

Lamari SC 4 TW (2200K–3000K)  
40dg x 65dg set to 3000K

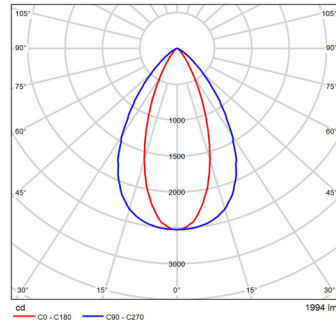

Distance [m]	Cone diameter [m]	Beam angle [°]	E(0°) [lx]	E(C90) [lx]	E(C180) [lx]
0.50	0.85 0.58	38.8°	10997	2970	4243
1.0	1.7 1.1	38.8°	2524	143	1991
1.5	2.5 1.6	38.8°	1322	77	1071
2.0	3.4 2.1	38.8°	631	41	565
2.5	4.3 2.6	38.8°	404	27	370
3.0	5.2 3.1	38.8°	280	19	261